

# Item: 11

## DC/20/3067/FUL

Proposed new welfare hub to include 3No cabins positioned on paving slab base to accommodate storage, wc's and coffee hut. Incl 2.4m high anti climb security fencing to perimeter plus security lighting.

Seaton Recreation Ground, Seaton Road, Felixstowe, IP11 9BS



# Site Location Plan

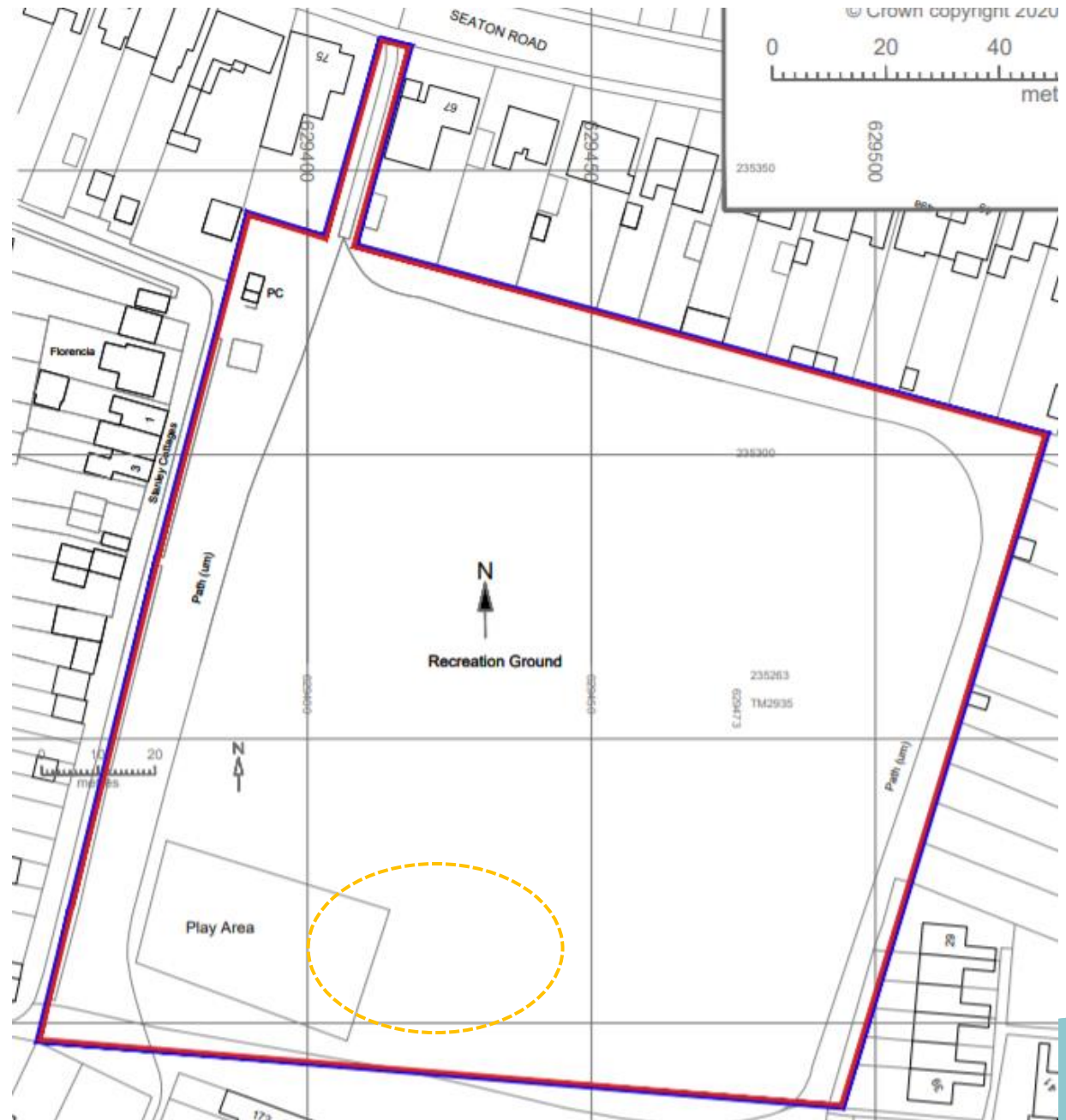

# Aerial View





# Photos (1 of 3)

1



2





# Photos (2 of 3)

1



2

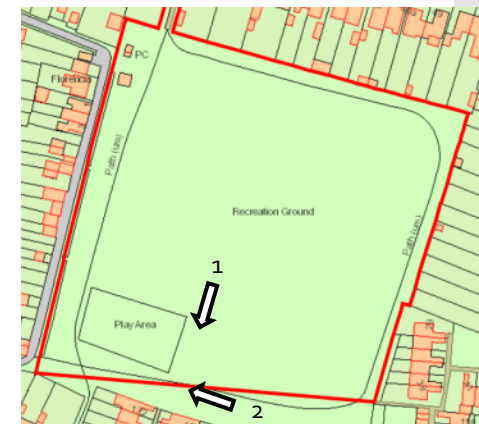



# Photos (3 of 3)

1



2



# Proposed Block Plan

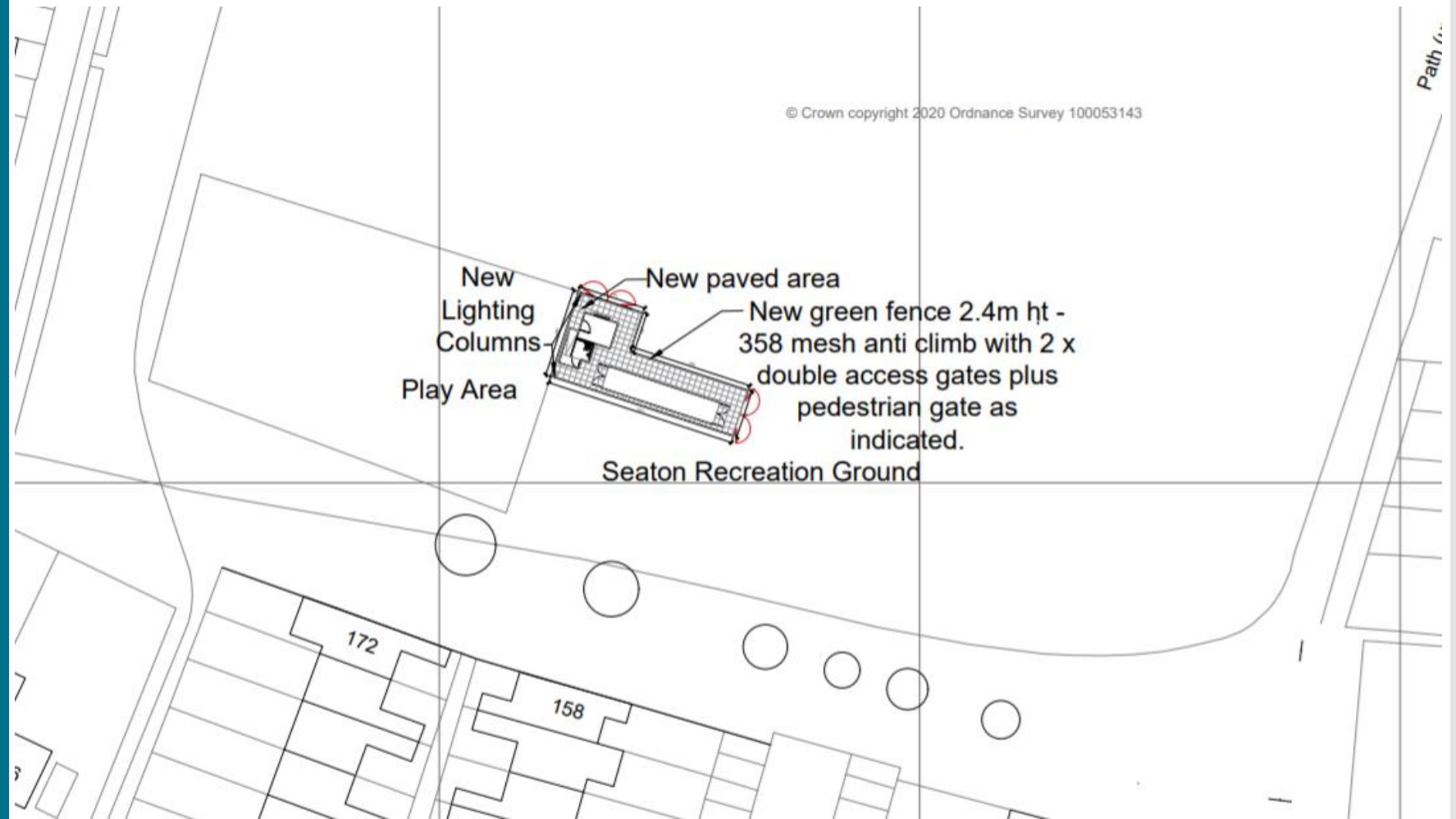

# Proposed Floor Plans

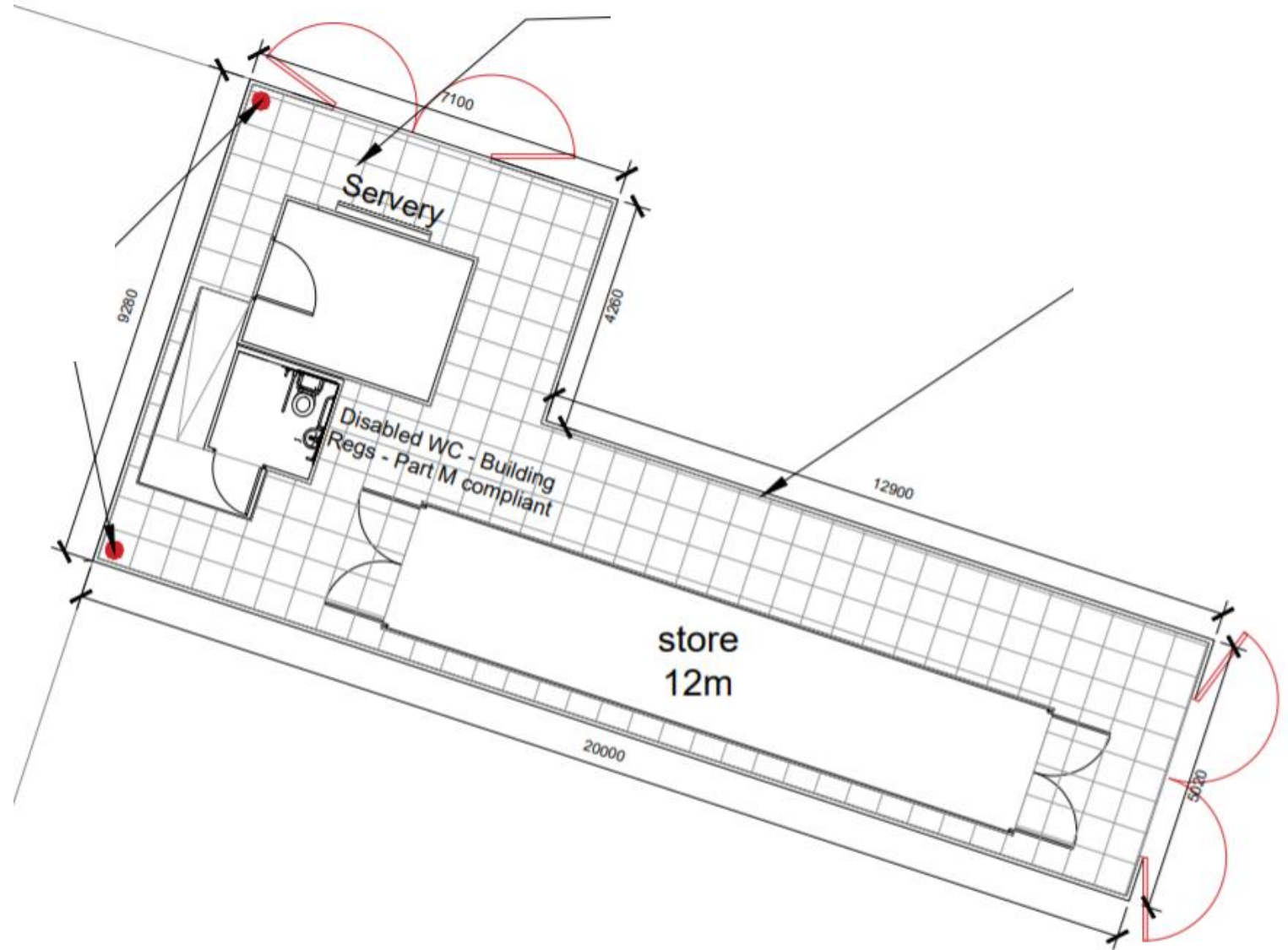



# Proposed Elevations

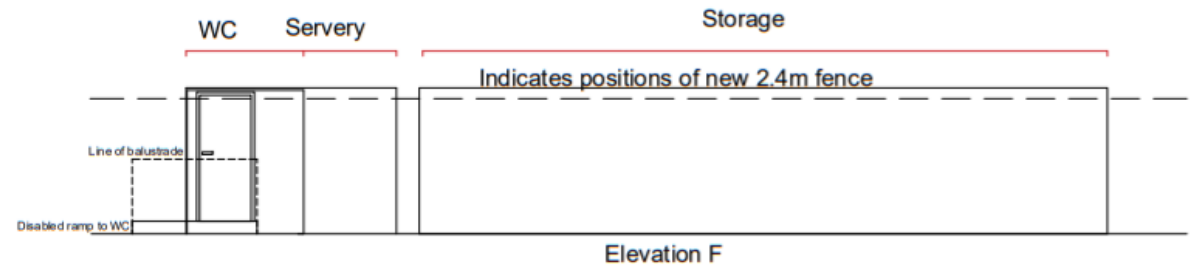
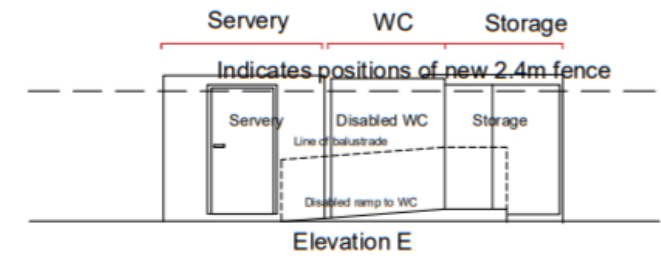
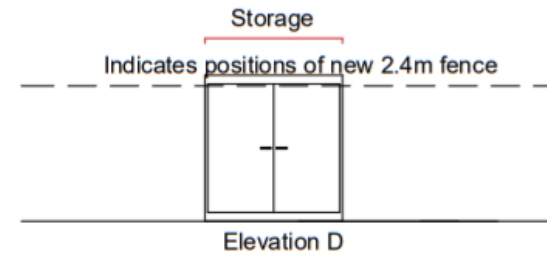
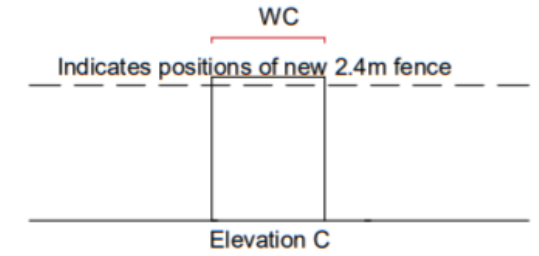
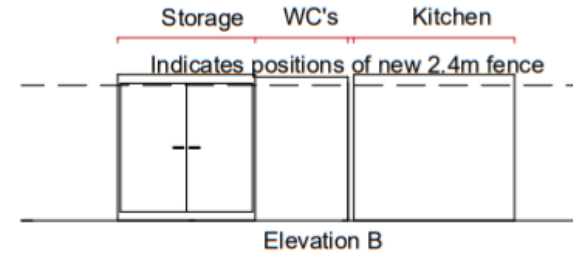
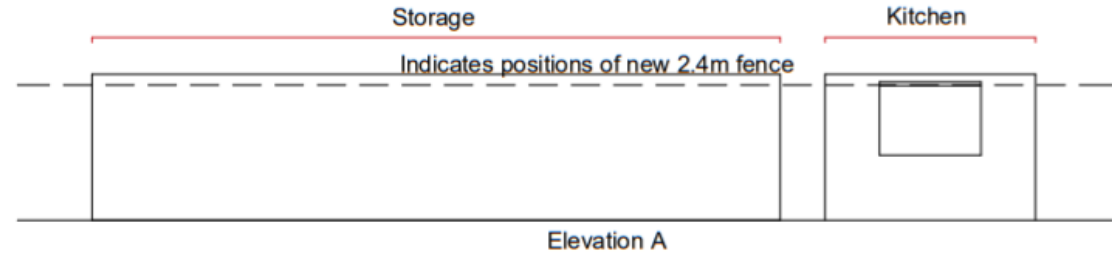
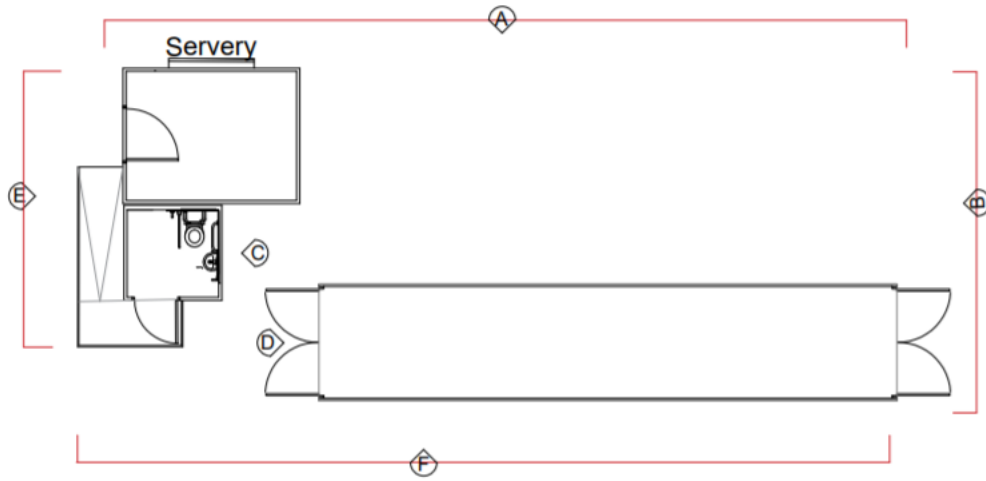

# Proposed Units/fence/ light photos

1



2



3



4



5





# Main Considerations

- **Benefits to community health and social wellbeing;**
  - **Increased offer of recreational activities and events at Seaton Park;**
  - **Encroachment on small area of recreation ground.**
- 
- A teal-colored decorative shape, resembling a stylized hill or a wave, is located in the bottom right corner of the slide.

# Recommendation

**Approve** planning permission subject to the conditions summarised below:

- 1) Standard three year time limit for implementation;
  - 2) Approved Plans/Drawings;
  - 3) Materials as submitted;
  - 4) No additional floodlighting or external lighting without prior approval of details;
  - 5) Lighting to be switched off when development not in use.
- 
- A teal-colored decorative shape, resembling a stylized wave or a triangle, is located in the bottom right corner of the slide.