

## Item 7

**DC/20/2441/FUL**

Trial for demountable concrete blocks to create a sand platform between groyne 105 and 106 in front of the Spa Pavilion, Felixstowe

The Spa Beach, The Promenade, Felixstowe



# Proposal and site description

The application proposes to undertake an engineering trial using two of the existing bays that beach huts at the Spa area are usually placed on. Following discussion and detailed feedback from the Coastal Management team, the two bays most appropriate for the trial are Bay C and Bay D.

The proposal is to be determined at Planning Committee as the applicant and landowner is East Suffolk Council.

The site comprises an area of beach immediately south of Felixstowe Promenade measuring approximately 40 square metres, located directly south of the Spa Pavilion and extending 180 metres westward. A number of beach huts are currently sited along the adjoining stretch of Promenade. These huts are in private ownership and the owners pay an annual licence fee to the Council to site them. Some hut sites are fixed either on hard-standing or sand and others are on the beach itself. Huts are moved between the beach and the Promenade at the start and end of the season (where beach levels allow).

# Site location plan

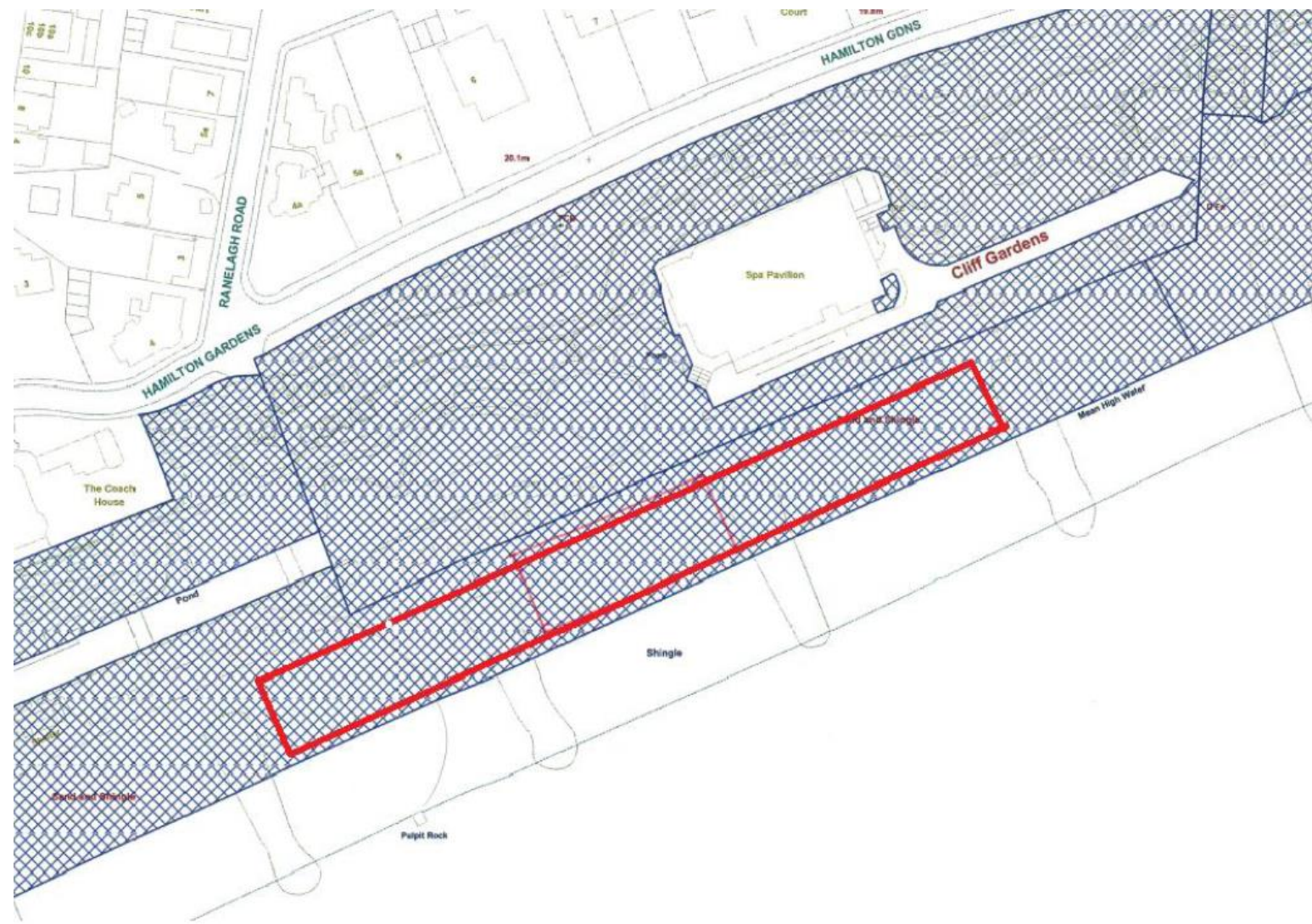

# Site plan: Bay C & Bay D

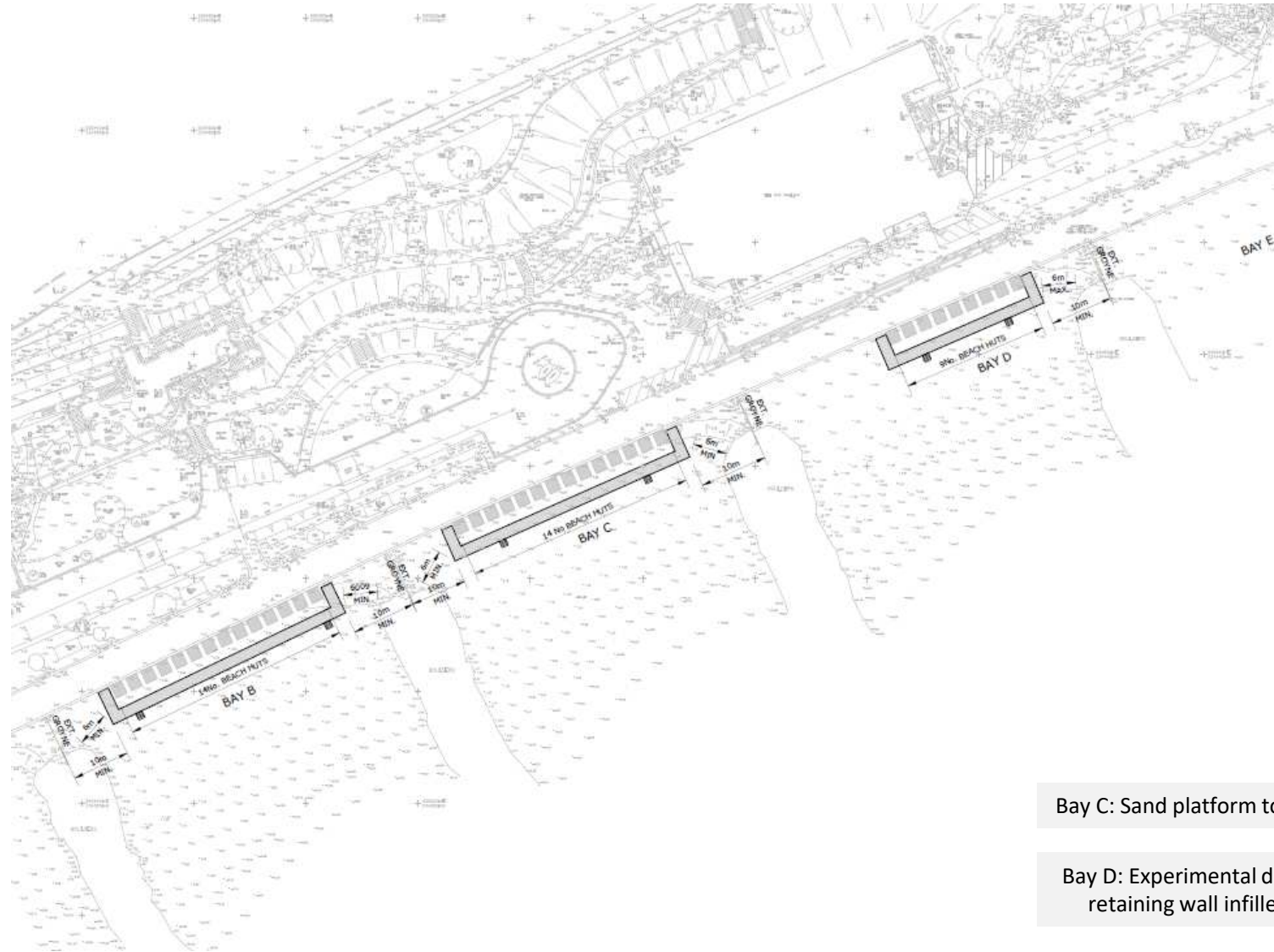

Bay C: Sand platform to act as baseline

Bay D: Experimental design (concrete retaining wall infilled with sand)



# Aerial view

Google ©

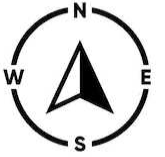

Site photos:  
Looking north from  
Bay C



Bay C



# Site photos:

Looking northeast  
from Bay C



Site photos:  
Looking north from  
Bay D





# Site photos:

Looking north from  
Bay D



Site photos:  
Looking northeast  
from Bay D



Bay D

Site photos:  
Looking west from  
Bay D





# Proposed plan

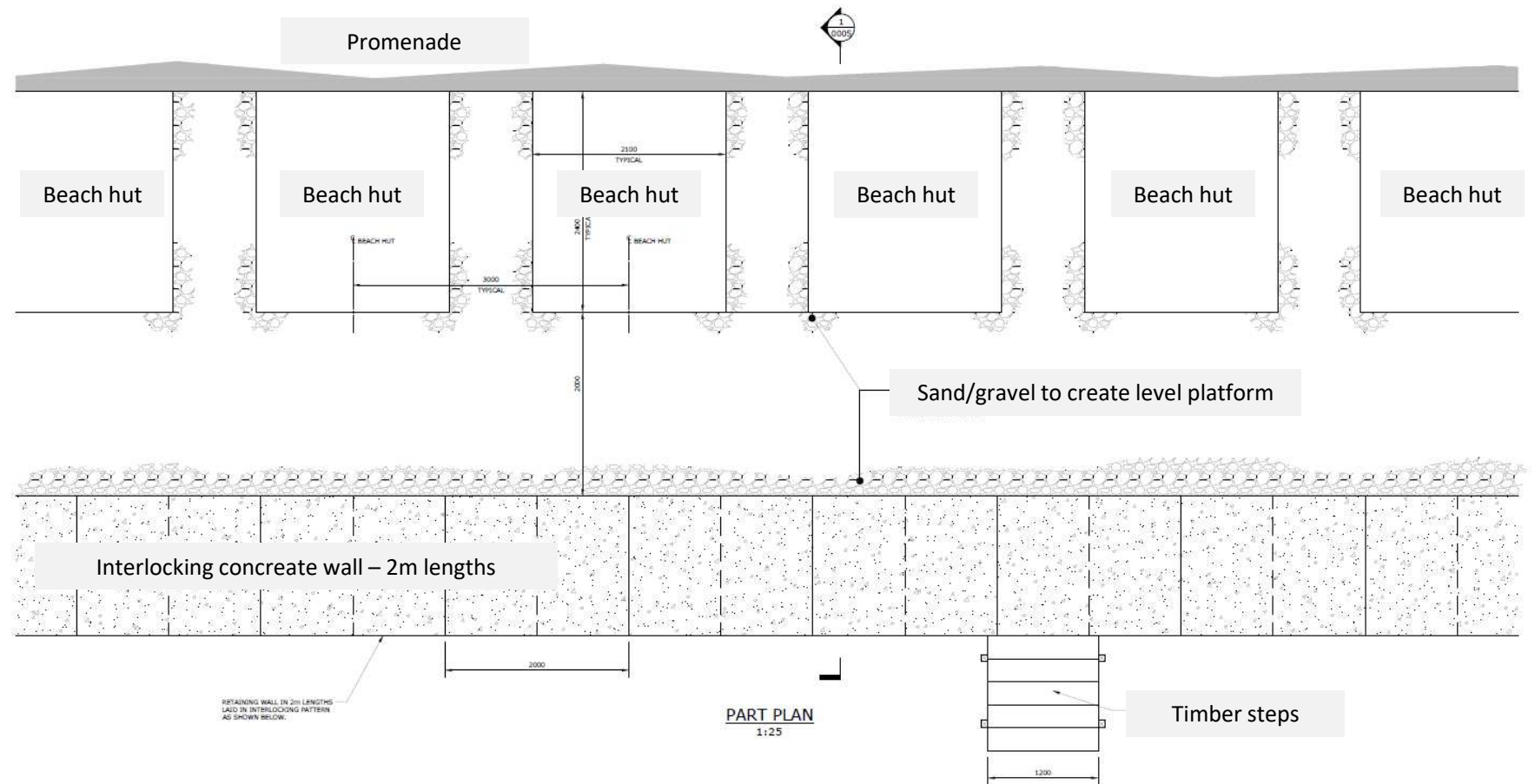

# Proposed section

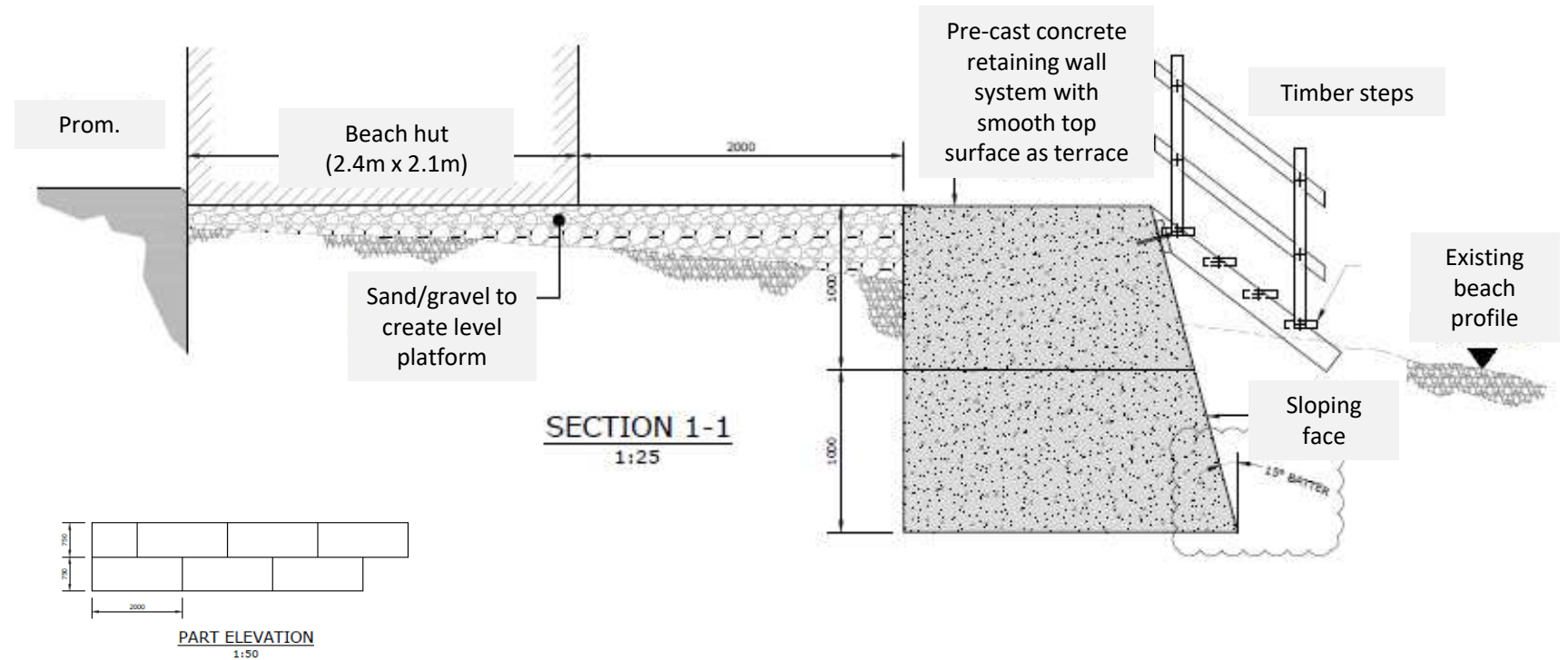

# Conclusion

Opportunities to retain the siting of beach huts within this location, with access to the beach and enhancing the use of the Promenade is in line with the overall strategy for Felixstowe. The proposal and its part in alleviating coastal erosion has been and will continue to be carefully overseen through partnership working, mitigation and management with the Coastal Management Team.

The proposed works are temporary in nature and further planning permission would be sought should the trialled solution be deemed appropriate.

The proposal does not result in an increase in beach hut provision and there will be no increased harm to visual amenity.

The application is recommended for approval subject to conditions.



# Recommendation

Recommended for **approval subject to conditions** – as outlined in the report:

- Standard three year expiration
- Temporary time limit (1 year)
- In accordance with submitted plans
- Materials inline with those proposed
- Extraction material strategy to be agreed before development commences
- Monitoring details to be agreed before development commences