

Item 6:

DC/20/1126/FUL

Change of use from Water machine manufacturing and distribution to Car Repairs and Sales premises by appointment only. Existing workshops at rear, existing showroom at front, existing offices adjoining showroom. Display of vehicles on existing concrete hardstanding at front of buildings.

Suffolk Cars, Halesworth Road, Bramfield, IP19 9HP



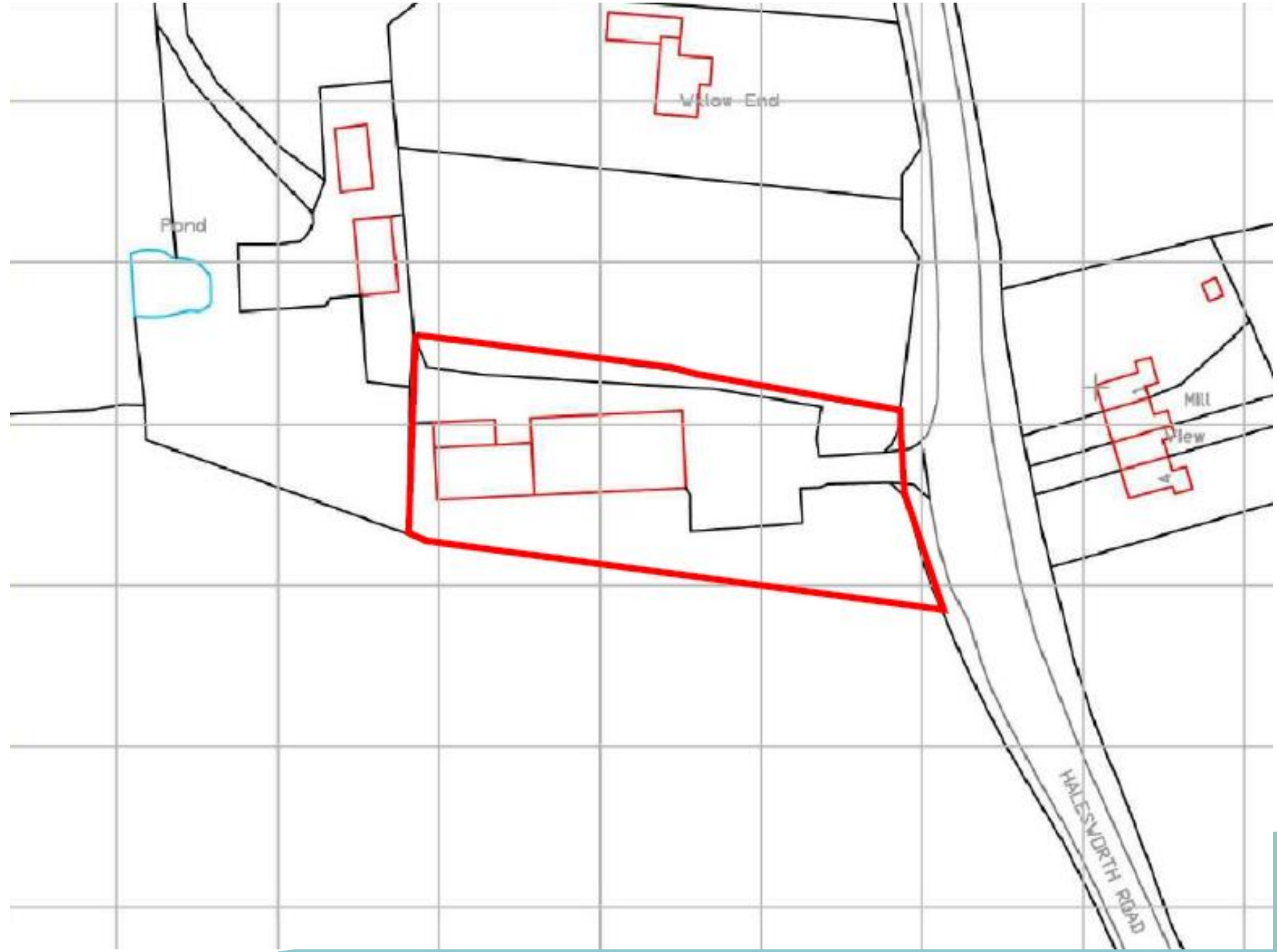





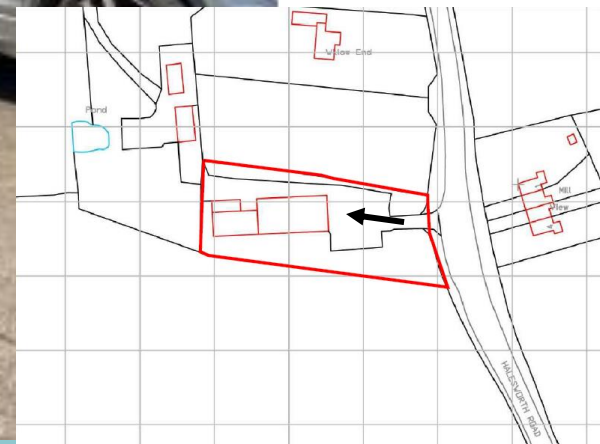

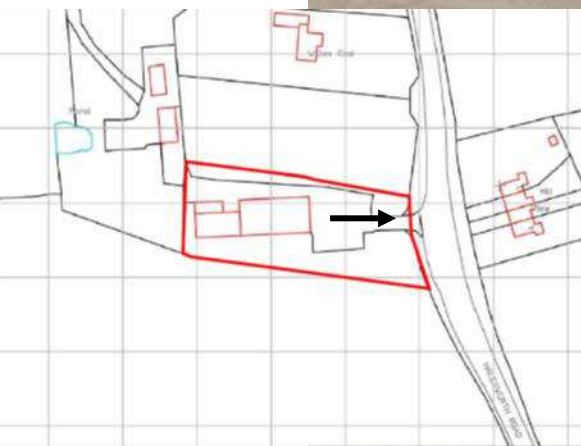

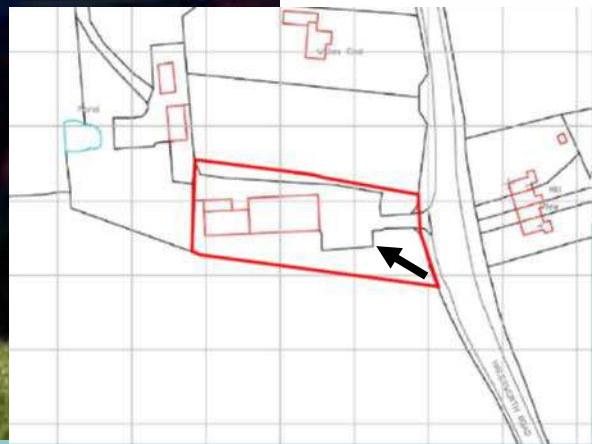

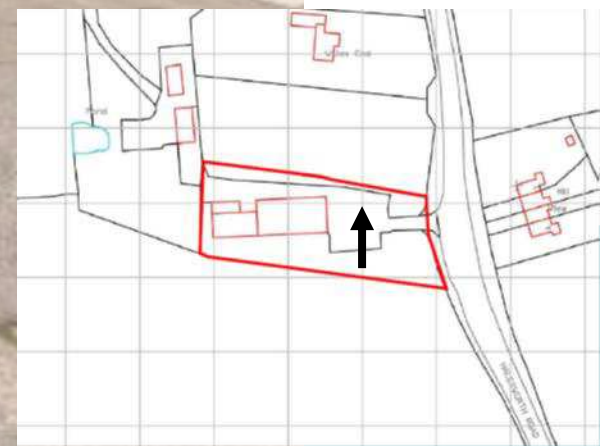

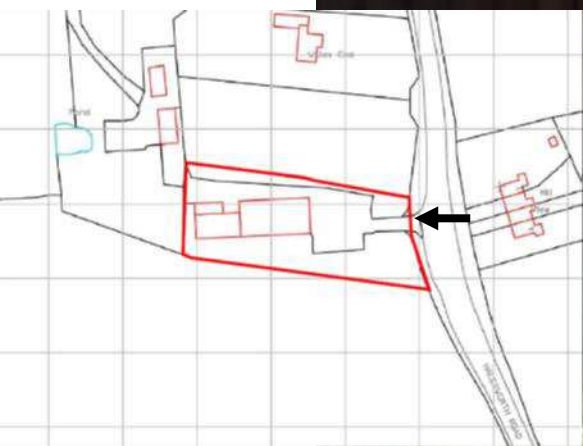



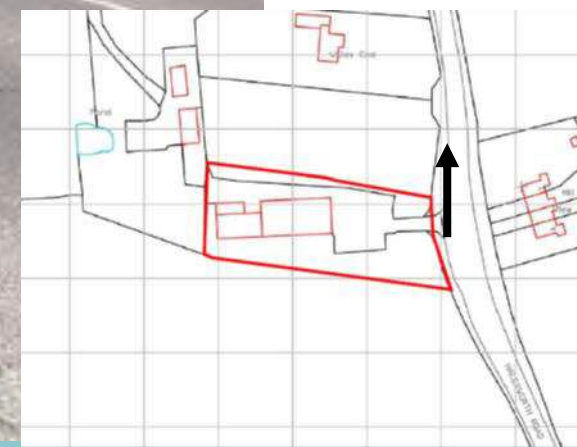

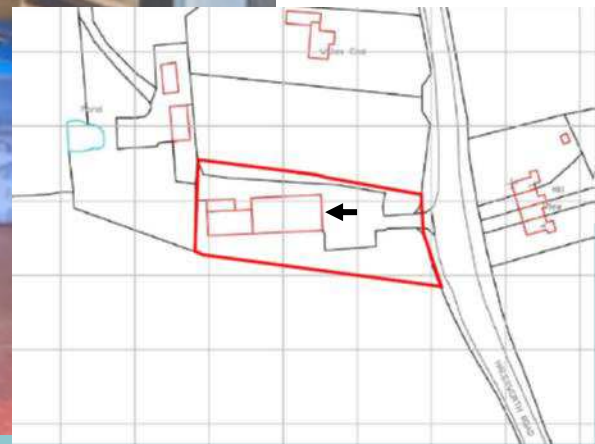
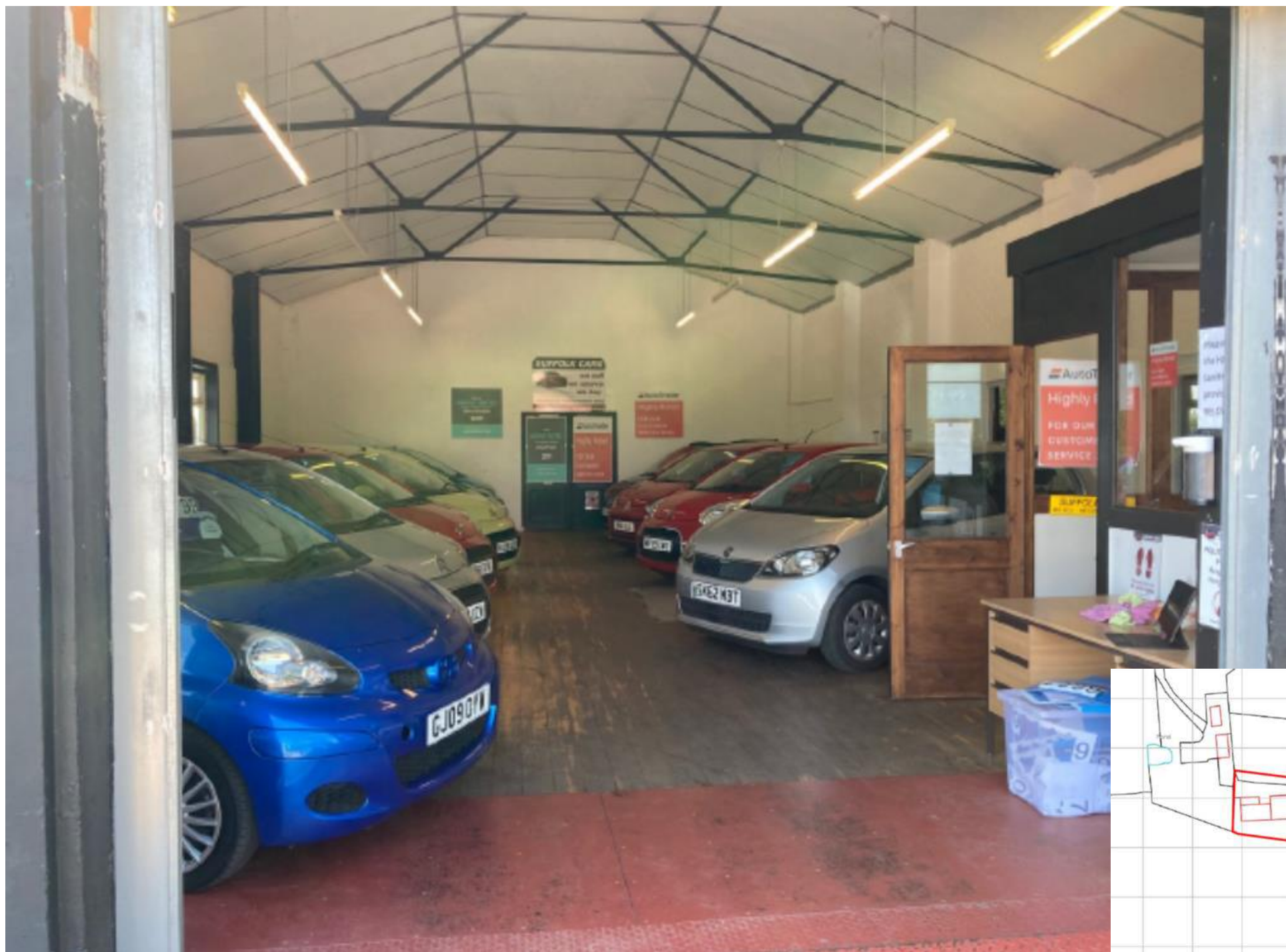



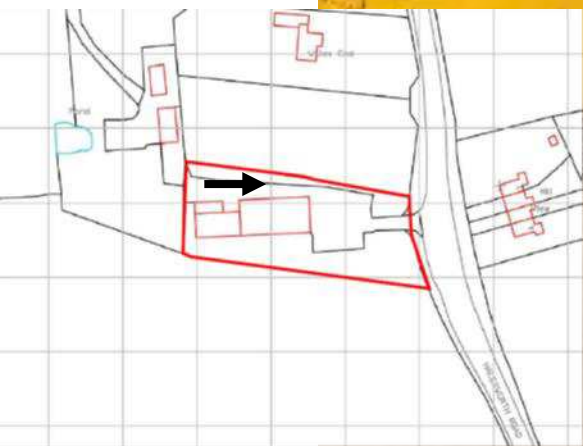



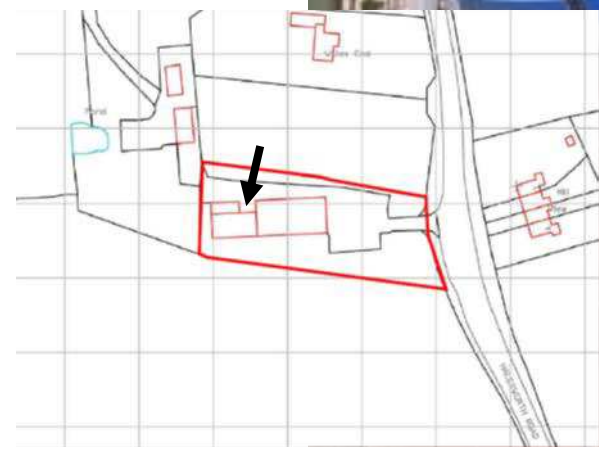



Material Considerations and Key Issues

- Continued commercial use and economic benefits.
- Residential amenity impact.
- Parking provision and highways safety.
- Use of planning conditions.

Recommendation

Approve subject to conditions as set out in the report/update sheet; summarised as follows:

1. Development to be in accordance with the approved plans/details.
2. Hours of working/operation and opening – (08:00 to 17:00 on Mondays to Saturdays)
3. The 4no. visitor car parking spaces shall be laid out, marked appropriately and made available within 3 months and retained solely for the approved purpose.
4. Only 23 sales vehicles shall be parked/displayed outside of the building and only in those areas denoted on the block plan.
5. The roller door to the loading bay on the northern side of the building shall remain closed at all times and only opened to allow for transport of goods and/or vehicles into the workshop areas.
6. Landscaping scheme to detail hedgerow planting on the southern edge of the site shall be submitted to and approved by the LPA; the planting scheme to then be implemented at the first available planting season, maintained and re-planted where required in first 5 years post-planting.