

Item: 10

DC/23/3527/FUL

Re-establish a driveway/access point to the property 1 Adams Lane from The Street - B1387.

1 Adams Lane  
Walberswick  
Suffolk  
IP18 6UR



# Aerial Photograph and Site Location Plan



# Photographs



# Photographs



# Photographs



# Photographs



# Existing block plan

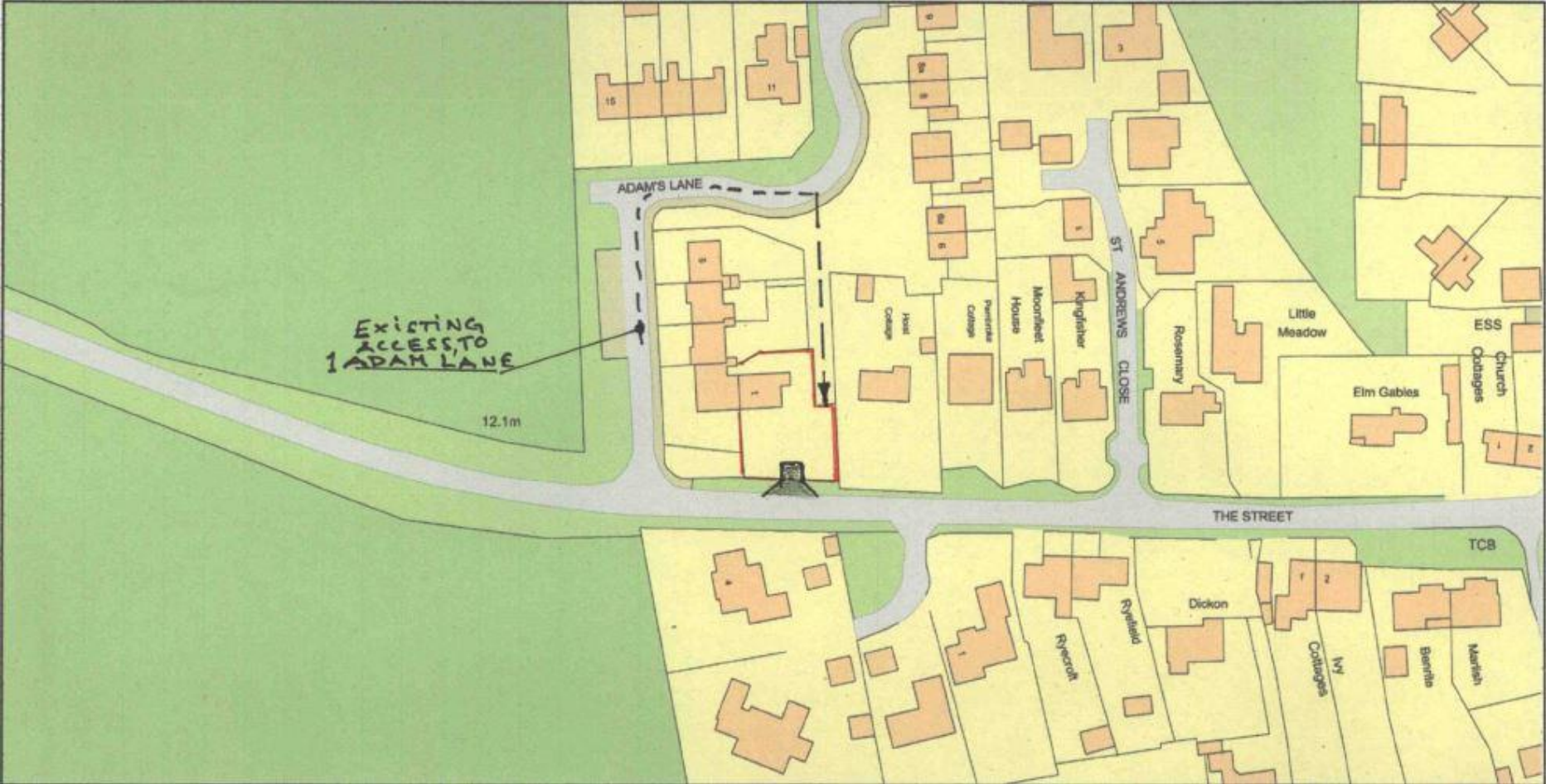

# Proposed block plan

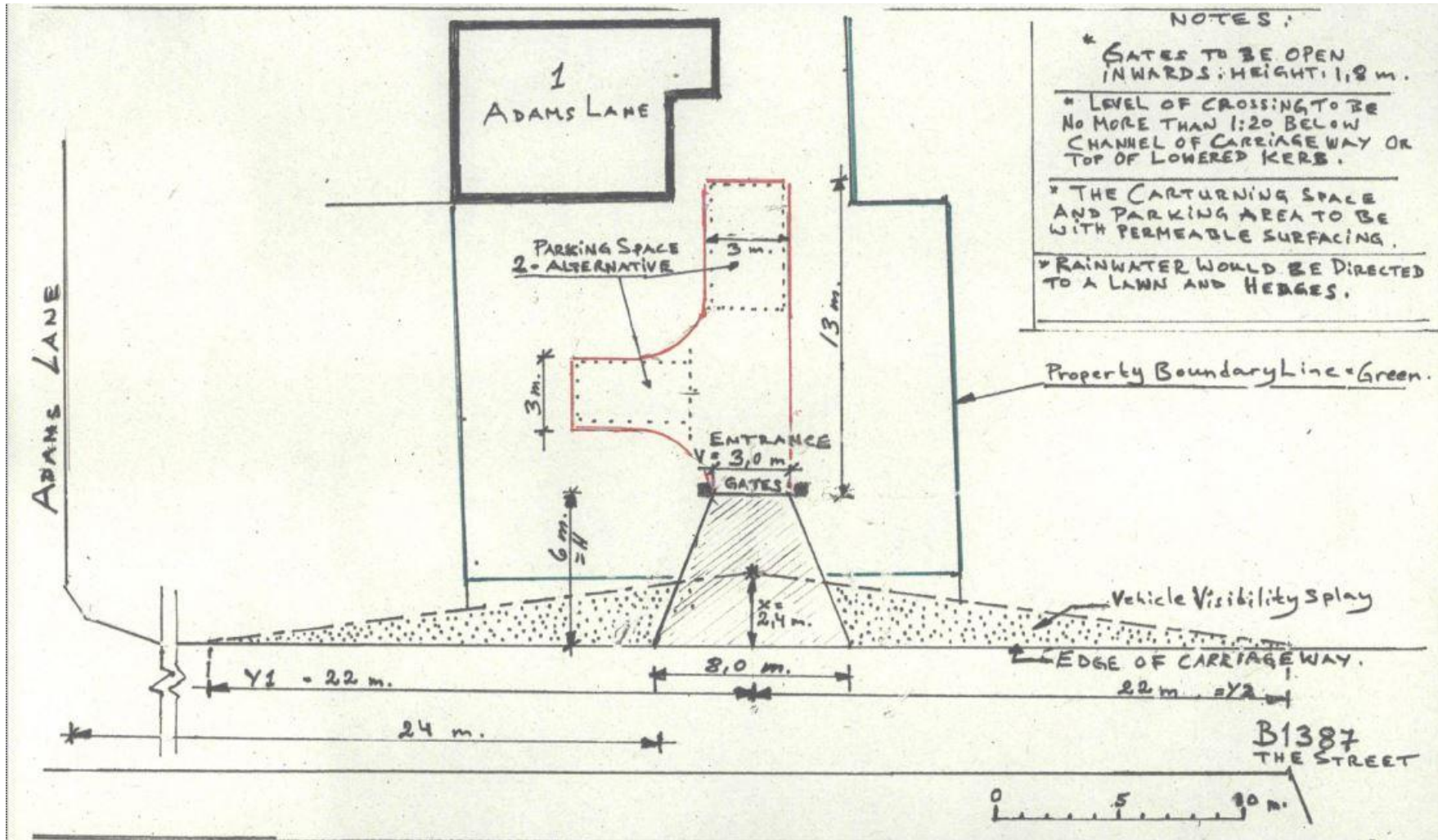



# Material Planning Considerations and Key Issues

- **Visual Impact**
- **Highway Safety**

## Recommendation

Recommendation for approval subject to conditions as outlined within the report – summarised below:

- **Time Limit**
- **Plans**
- **Materials**
- **Visibility Condition**
- **Access Condition**
- **Access Gradient Condition**
- **Driveway Gradient Condition**
- **Access Barrier Condition**
- **Surfacing Condition**
- **Vehicle Parking Condition**
- **Surface Water Condition**