

Item: 10

DC/23/4817/FUL

Remove hedge on boundary and replace
with 2m high close boarded fence

1 Broadland Close, Worlingham, Beccles
NR34 7AT





Broadland Ct

Sheridan Walk

Broadland Ct

Sheridan Walk

Highland Dr

Highland Dr

Sheridan Walk

Sheridan Walk

Proposed Location & Block plans

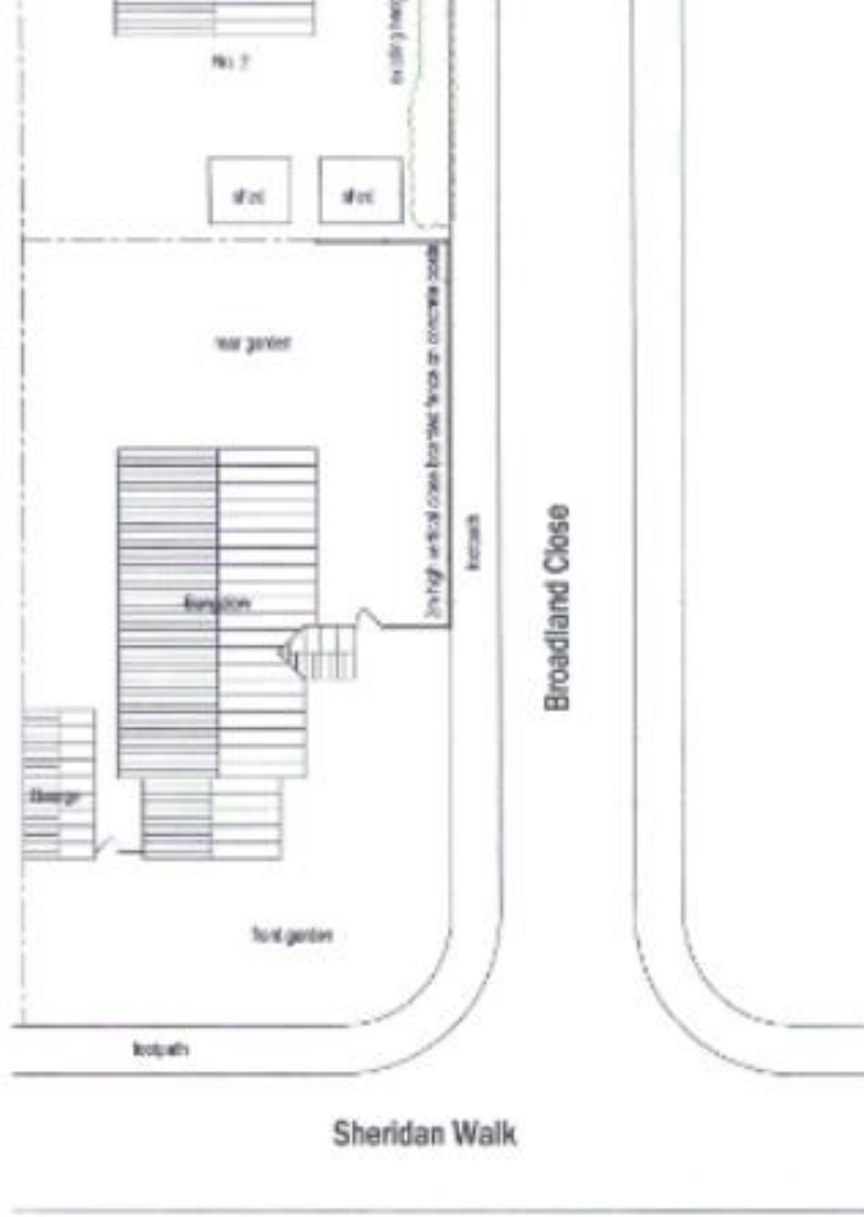

1. Broadland Close, Worthing, Sussex, NE24 7AT



1, Broadland Close Worthing BECCLES	Mr & Mrs D Punt	Drawing: Proposed Plan Date: December 2023	Drawing Number 199 04
-------------------------------------------	-----------------	-----------------------------------------------	---------------------------------

Proposed elevations



VIEW FROM BROADBAND CLOSE

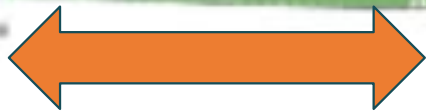

VIEW FROM BROADBAND HALL

EXISTING ELEVATIONS



VIEW FROM BROADBAND CLOSE



VIEW FROM BROADBAND HALL

PROPOSED ELEVATIONS

<p>L. Broadband Close Wolfehampton</p>	<p>M & Mrs D Punt</p>	<p>Drawing: Elevations Date: November 2013</p>	<p>Drawing Number 100-05</p>
--------------------------------------------	---------------------------	----------------------------------------------------	----------------------------------

Photographs



Feb 2024

Photographs

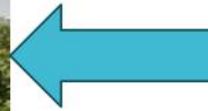

2019



Feb 2024



Photographs



Directly opposite
the site



No.12 Broadland Close

Photographs



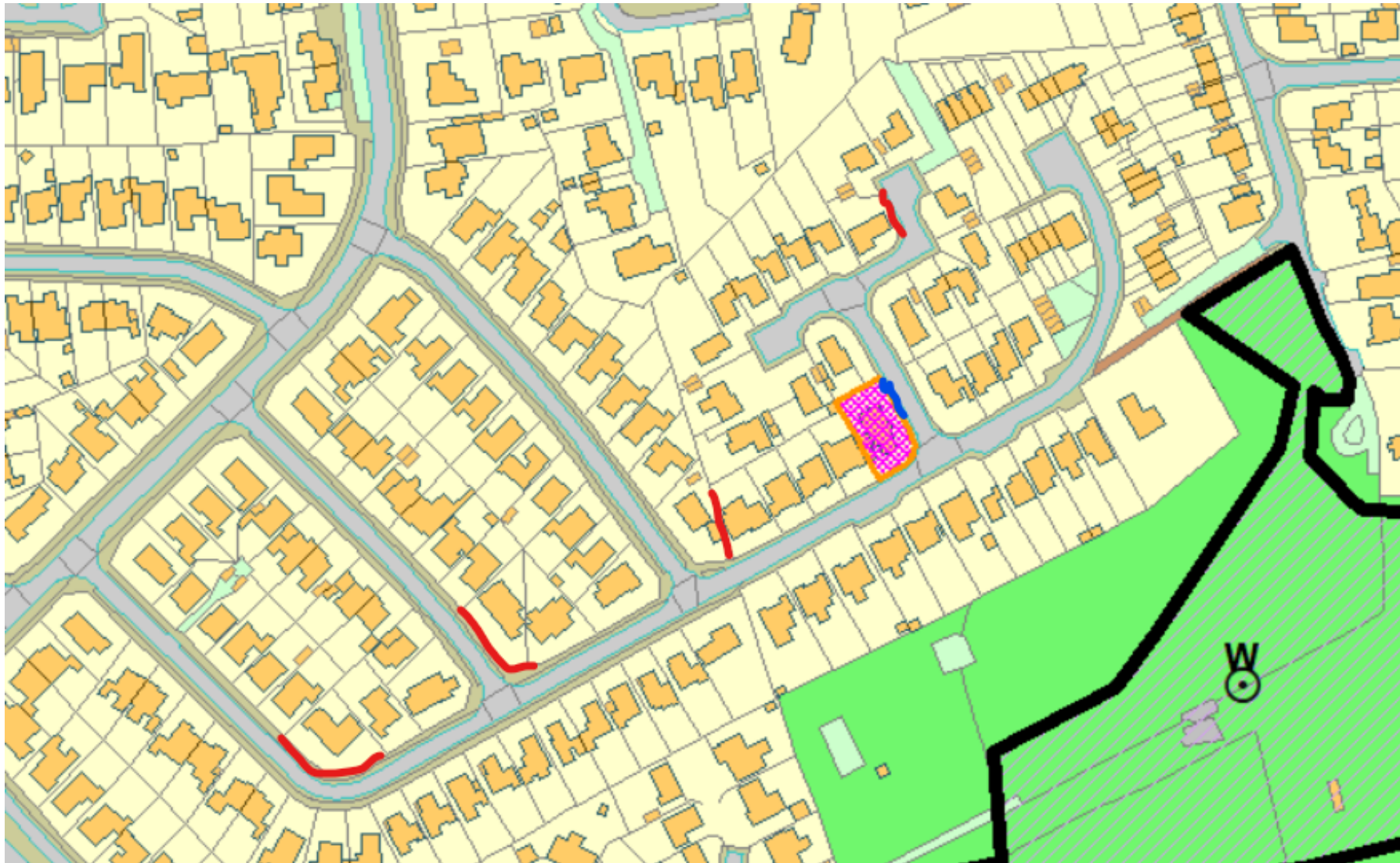

= application proposal



= Other 2m high fences adjacent to highway in vicinity of the site



12 Broadland Close, 50m northeast of site.



Corner of Worrell Drive and Sheridan Walk,
120m west of site.



1 Sheridan Walk, 4 doors up from site, high fence erected up to highway edge, blocking visibility



Corner of Highland Drive, Less than 200m from site, tall fence erected all around the front corner.

Retrospective planning permission granted on appeal, and enforcement notice not upheld.

AFTER APPEAL ALLOWED



BEFORE

Recommendation

Approve with conditions set out in section 11 of the Committee Report.



















