



Licensing Sub-Committee

Members are invited to a **Meeting of the Licensing Sub-Committee** to be held in the Deben Conference Room, East Suffolk House, Melton on **Monday, 11 December 2023 at 2:30pm**

This meeting will be broadcast to the public via the East Suffolk YouTube Channel at <https://youtube.com/live/RrkZSzoZh1s?feature=share>

Members:

Councillor John Fisher, Councillor Mark Jepson, Councillor Tim Wilson, Councillor Rachel Smith-Lyte (Reserve)

An Agenda is set out below.

Part One – Open to the Public

Pages

- 1 Election of a Chair**
To elect a Chair for the Licensing Sub-Committee.
- 2 Apologies for Absence**
To receive apologies for absence, if any.
- 3 Declarations of Interest**
Members and Officers are invited to make any declarations of interests, and the nature of that interest, that they may have in relation to items on the Agenda and are also reminded to make any declarations at any stage during the Meeting if it becomes apparent that this may be required when a particular item or issue is considered.
- 4 Declarations of Lobbying and Responses to Lobbying**
To receive any Declarations of Lobbying in respect of any item on the agenda and also declarations of any response to that lobbying.
- 5 Variation of Premises Licence - Thorpeness Country Club, The Benthills, Thorpeness, Leiston, Suffolk, IP16 4NU ES/1762**
Report of the Licensing Officer 1 - 20

Part Two – Exempt/Confidential

Pages

There are no Exempt or Confidential items for this Agenda.

Close



Chris Bally, Chief Executive

If you require this document in large print, audio or Braille or in a different language, please contact the Democratic Services Team on 01502 523521 or email:

democraticservices@eastsoffolk.gov.uk

Filming, Videoing, Photography and Audio Recording at Council Meetings

The Council, members of the public and press may record / film / photograph or broadcast this meeting when the public and press are not lawfully excluded.

The Council cannot guarantee public seating areas will not be filmed or recorded. By entering the Conference Room and sitting in the public seating area, those present will be deemed to have consented to the possible use of filmed images and sound recordings. If you do not wish to be recorded, please speak to a member of the Democratic Services team at the earliest opportunity.



The national Charter and Charter Plus Awards for Elected Member Development

East Suffolk Council is committed to achieving excellence in elected member development

www.local.gov.uk/Community-Leadership



LICENSING SUB-COMMITTEE

Friday 11 December 2023

APPLICATION DETAILS

Type:	Variation – Premises Licence
Name of Applicant(s):	The Hotel Folk
Address of Applicant(s):	The Hotel Folk Ltd, Lakeside Avenue, Thorpeness, Leiston Suffolk IP16 4NH
Type of applicant (Premises Only):	Limited Company
Name of Premises:	Thorpeness Leiston
Address of premises:	Thorpeness Country Club, The Benthills, Thorpeness Leiston IP16 4NU
Description of Premises:	Country club and events venue

EXECUTIVE SUMMARY:

<ul style="list-style-type: none"> • This is an application for a variation to an existing Premises Licence. • The application seeks to extend the licensed times for live and recorded music indoors, to add live and recorded music on an outside lawn area and to remove old, obsolete conditions imposed under the now repealed licensing regime.

Is the report Open or Exempt?	Open
-------------------------------	------

Wards Affected:	Aldeburgh & Leiston
------------------------	---------------------

Cabinet Member:	Councillor Jan Candy, Cabinet Member with responsibility for Community Health
------------------------	---

Supporting Officer:	Jodie Fisher Licensing Officer 01394 444363 Jodie.Fisher@eastsoffolk.gov.uk
----------------------------	---

1. PROPOSED LICENSABLE ACTIVITIES

Live Music – outdoors (lawn area)

Monday to Sunday 10:00 to 00:00

Recorded Music – outdoors (lawn area)

Monday to Sunday 10:00 to 00:00

Supply of alcohol – off Sales

Monday to Sunday 10:00 to 00:00

1.1 EXISTING LICENCED TIMES FOR ACTIVITIES

Live Music – indoors

Monday to Saturday 10:00 to 00:00

Sunday 10:00 to 22:30

Recorded Music – indoors

Monday to Saturday 10:00 to 00:00

Sunday 10:00 to 22:30

Performance of Dance – indoors

Monday to Saturday 10:00 to 00:00

Sunday 10:00 to 22:30

Late night refreshments – indoors

Monday to Sunday 23:00 to 00:00

Supply of alcohol – ON premises

Monday to Saturday 10:00 to 00:00

Sunday 10:00 to 22:30

2. PROPOSED OPENING HOURS

Monday to Sunday 08:00 to 00:00

Easter Sunday 06:00 to 00:00

New Years Eve 08:00 to 01:00

2.1. EXISTING OPENING HOURS

Monday to Saturday 10:00 to 00:00

Sunday 10:00 to 22:30

3. OPERATING SCHEDULE

3.1 The following steps have been proposed in order to promote the four licensing objectives. These are proposals offered by the applicant and in their own words. Some submissions may already form part of the licence, as mandatory conditions; others may be re-worded by officers to form meaningful, enforceable conditions on the licence.

To keep all existing relevant conditions and to also add these conditions:

General

Keeping a log of refusals for sales

We operate a challenge 25 policy.

All staff have completed licensing training, bar staff, waiting staff and managers.

Prevention of crime and disorder

Training is given to staff to ensure they understand licensing laws and how to prevent crime and disorder.

We conduct regular checks of toilets and other public areas to prevent unacceptable or illegal activity and to ensure it is kept clean and tidy.

Public safety

Event staffing is based on the number of guests attending.

Our risk assessments are reviewed for the requirements of each event.

We have a safeguarding policy in place.

Prevention of public nuisance

The use of The Beach side lawn will not be permitted after 10pm

The volume of amplified music will be strictly controlled in all areas.

Protection of children from harm

We operate a challenge 25 policy.

Events have specific guest lists; we know the amount of children in attendance.

Safeguarding policy in place with a company designated safeguarding officer for The Hotel Folk.

The summer programme have additional risk assessments.

A copy of the existing premises licence and the existing plan of the premises licence are attached as **Appendix A & A1**.

A copy of the new plan of the premises including the new proposed licence area is attached as **Appendix B**.

4. REASON FOR HEARING

4.1 Seven representations against the application have been received from other persons.

4.2 The applicant has been provided with a copy of these representations and these are attached as **Appendix C** for members of the Sub-Committee.

4.3 No representations against the application were received from any of the Responsible Authorities.

4.4 Summary of grounds for representation:

We are currently inconvenienced periodically by the noise from wedding discos held at the County Club.

Acoustic noise will definitely pollute that stretch of beach and all the surrounding homes/holiday lets.

There is a potential danger to the public, particularly children, due to the location of the site being on the opposite side of the highway (B1353) to the premises of the Country Club.

The creation of the beachside lawn venue with the sale of alcohol, live and recorded music, potentially every afternoon and evening seven days a week will cause a significant and unacceptable public nuisance.

5. POINTS FOR CONSIDERATION

5.1 In exercising its licensing functions, the Licensing Authority has stated in its licensing policy that it will primarily focus on the direct impact of the licensable activities taking place at the licensed premises on members of the public living, working or engaged in normal activity in the vicinity of the premises.

5.2 The attention of the Sub-Committee is drawn to the following:

- a) The Licensing Act 2003 Section 4 requires the Sub-Committee to have regard to:
 - Guidance Issued under Section 182 of the Licensing Act 2003.
 - The Council's Statement of Licensing Policy

If the Sub-Committee has reason to depart from the above it is asked to give full reasons for so doing.

- b) Human Rights Act 1998

The Human Rights Act 1998 came into force on the 2 October 2000. The Sub-Committee is urged to have careful regard of its provisions.

It is unlawful for a public authority (this expression includes local authorities) to act in a way which is incompatible with a human right.

As far as the applicant's right to a fair hearing is concerned (Article 6), the applicant has a right to be heard by the Licensing Sub-Committee. If this application is refused or granted subject to modification, the applicant has a right of appeal to the Magistrates' Court.

In assessing the impact of human rights, the Sub-Committee must seek to strike a balance between the right of the proprietors in the business to conduct it as they wish and local residents who may find its activities intrusive. In this context a business is a "possession" and the human right is expressed to be for the "peaceful enjoyment" of it. A rider to this human right empowers the Council to control the enjoyment of that business by its proprietors in the general interest. At the same time, local residents are entitled to the peaceful enjoyment of their homes.

5.3 The relevant notices about this hearing have been served on the applicant and other persons and they have until 5 December 2023 to confirm that they intend to attend, or not, as the case may be and give notice that they wish to call witnesses.

6. CONCLUSION

6.1 The applicant has been advised of the representations that have been made and there may be mediation between the applicant and the other persons before the hearing in order to achieve agreement. In the event that an agreement is not possible, the Sub-Committee will be asked to determine this application by:

- Granting the application subject to such conditions as are consistent with the operating schedule accompanying the application and any condition which must be included in the licence in accordance with the Licensing Act 2003.
- Granting the application subject to such conditions as are consistent with the operating schedule accompanying the application, modified to such extent as the Sub-Committee considers appropriate for the promotion of the licensing objectives (for example, by excluding a licensable activity or restricting the hours when a licensable activity can take place), and any condition which must be included in the licence in accordance with the Licensing Act 2003.
- Rejecting the application.

6.2 If the decision reached by the Sub-Committee results in differences between the conditions attached to the licence and the planning permission currently in force for these premises, the applicant should be advised that the planning permission must be adhered to unless and until it is amended to reflect the conditions attached to the licence.

6.3 Depending on the decision of the Sub-Committee, the applicant and / or responsible authority and interested parties that have made representations have rights of appeal to the Magistrates Court.

6.4 When announcing its decision, the Sub-Committee is asked to state its reasons.

APPENDICES	
Appendix A	A copy of the existing premises licence
Appendix A1	A copy of the plan that accompanies the existing premises licence
Appendix B	A copy of the plan for the proposed variation
Appendix C	Representations (private document for the Sub-Committee only)

BACKGROUND PAPERS	
None	

Licensing Act 2003
Premises Licence

PREM0165 ES/1762

LOCAL AUTHORITY	
 <p>EASTSUFFOLK COUNCIL</p>	<p>East Suffolk Council East Suffolk House Riduna Park Station Road Melton Woodbridge IP12 1RT</p> <p>tel: 01394 444802 web: www.eastsuffolk.gov.uk</p>

Part 1 - Premises Details

POSTAL ADDRESS OF PREMISES, OR IF NONE, ORDNANCE SURVEY MAP REFERENCE OR DESCRIPTION	
<p>Thorpeness Country Club The Benthills, Thorpeness, Leiston, Suffolk, IP16 4NU.</p>	<p>Telephone 01728 452176</p>

WHERE THE LICENCE IS TIME LIMITED THE DATES
Not applicable

LICENSABLE ACTIVITIES AUTHORISED BY THE LICENCE
<ul style="list-style-type: none"> - a performance of live music - any playing of recorded music - a performance of dance - provision of late night refreshment - the supply of alcohol

THE TIMES THE LICENCE AUTHORISES THE CARRYING OUT OF LICENSABLE ACTIVITIES			
Activity (and Area if applicable)	Description	Time From	Time To
E. Performance of live music (Indoors)	Monday to Saturday	10:00am	Midnight
	Sunday	10:00am	10:30pm
F. Playing of recorded music (Indoors)	Monday to Saturday	10:00am	Midnight
	Sunday	10:00am	10:30pm
G. Performance of dance (Indoors)	Monday to Saturday	10:00am	Midnight
	Sunday	10:00am	10:30pm
I. Late night refreshment (Indoors)	Monday to Sunday	11:00pm	Midnight
J. Supply of alcohol for consumption ON the premises only	Monday to Saturday	10:00am	Midnight
	Sunday	10:00am	10:30pm

THE OPENING HOURS OF THE PREMISES			
	Description	Time From	Time To
	Monday to Saturday	10:00am	Midnight
	Sunday	10:00am	10:30pm



Licensing Act 2003
Premises Licence

PREM0165

WHERE THE LICENCE AUTHORISES SUPPLIES OF ALCOHOL WHETHER THESE ARE ON AND / OR OFF SUPPLIES

- J. Supply of alcohol for consumption ON the premises only

Part 2

NAME, (REGISTERED) ADDRESS, TELEPHONE NUMBER AND EMAIL (WHERE RELEVANT) OF HOLDER OF PREMISES LICENCE

The Hotel Folk
headoffice@thehotelfolk.co.uk Thorpeness Hotel & Golf Club, Lakeside Avenue, Thorpeness, Suffolk, IP16 4NH.
Telephone 01728 451077

REGISTERED NUMBER OF HOLDER, FOR EXAMPLE COMPANY NUMBER, CHARITY NUMBER (WHERE APPLICABLE)

The Hotel Folk 3098213

NAME, ADDRESS AND TELEPHONE NUMBER OF DESIGNATED PREMISES SUPERVISOR WHERE THE PREMISES LICENCE AUTHORISES THE SUPPLY OF ALCOHOL

Lynne Mair WRIGHT 1 The Old Pavillion, Thorpe Road, Thorpeness, Leiston, Suffolk, IP16 4FD.

PERSONAL LICENCE NUMBER AND ISSUING AUTHORITY OF PERSONAL LICENCE HELD BY DESIGNATED PREMISES SUPERVISOR WHERE THE PREMISES LICENCE AUTHORISES FOR THE SUPPLY OF ALCOHOL

Licence No. PL12570 Issued by Plymouth



Premises Licence

ANNEXES

Annex 1 - Mandatory Conditions

Where a premises licence authorises the sale of alcohol, the licence must include the following conditions:

1. (1) No supply of alcohol may be made under the premises licence -
 - At any time when there is no designated premises supervisor in respect of the premises, or
 - At a time when the designated premises supervisor does not hold a personal licence or his personal licence is suspended.

(2) Every supply of alcohol under the premises licence must be made or authorised by a person who holds a personal licence.

2. (1) The responsible person must ensure that staff on relevant premises do not carry out, arrange or participate in any irresponsible promotions in relation to the premises.

(2) In this paragraph, an irresponsible promotion means any one or more of the following activities, or substantially similar activities, carried on for the purpose of encouraging the sale or supply of alcohol for consumption on the premises-

 - (a) games or other activities which require or encourage, or are designed to require or encourage, individuals to-
 - (i) drink a quantity of alcohol within a time limit (other than to drink alcohol sold or supplied on the premises before the cessation of the period in which the responsible person is authorised to sell or supply alcohol), or
 - (ii) drink as much alcohol as possible (whether within a time limit or otherwise);
 - (b) provision of unlimited or unspecified quantities of alcohol free or for a fixed or discounted fee to the public or to a group defined by a particular characteristic in a manner which carries a significant risk of undermining a licensing objective;
 - (c) provision of free or discounted alcohol or any other thing as a prize to encourage or reward the purchase and consumption of alcohol over a period of 24 hours or less in a manner which carries a significant risk of undermining a licensing objective;
 - (d) selling or supplying alcohol in association with promotional posters or flyers on, or in the vicinity of, the premises which can reasonably be considered to condone, encourage or glamorise anti-social behaviour or to refer to the effects of drunkenness in any favourable manner;
 - (e) dispensing alcohol directly by one person into the mouth of another (other than where that other person is unable to drink without assistance by reason of disability).

3. The responsible person must ensure that free potable water is provided on request to customers where it is reasonably available.

4. (1) The premises licence holder or club premises certificate holder must ensure that an age verification policy is adopted in respect of the premises in relation to the sale or supply of alcohol.

(2) The designated premises supervisor in relation to the premises licence must ensure that the supply of alcohol at the premises is carried on in accordance with the age verification policy.

(3) The policy must require individuals who appear to the responsible person to be under 18 years of age (or such older age as may be specified in the policy) to produce on request, before being served alcohol, identification bearing their photograph, date of birth and either-

 - (a) a holographic mark, or
 - (b) an ultraviolet feature.

5. The responsible person must ensure that-



ANNEXES continued ...

(a) where any of the following alcoholic drinks is sold or supplied for consumption on the premises (other than alcoholic drinks sold or supplied having been made up in advance ready for sale or supply in a securely closed container) it is available to customers in the following measures-

- (i) beer or cider: ½ pint;
- (ii) gin, rum, vodka or whisky: 25 ml or 35 ml; and
- (iii) still wine in a glass: 125 ml;

(b) these measures are displayed in a menu, price list or other printed material which is available to customers on the premises; and

(c) where a customer does not in relation to a sale of alcohol specify the quantity of alcohol to be sold, the customer is made aware that these measures are available.”

6. A relevant person shall ensure that no alcohol is sold or supplied for consumption on or off the premises for a price which is less than the permitted price.

6.1 For the purposes of the condition set out in paragraph 1

(a) “duty” is to be construed in accordance with the Alcoholic Liquor Duties Act 1979(a);

(b) “permitted price” is the price found by applying the formula-

$$P = D + (D \times V)$$

where-

- (i) P is the permitted price,
- (ii) D is the amount of duty chargeable in relation to the alcohol as if the duty were charged on the date of the sale or supply of the alcohol, and
- (iii) V is the rate of value added tax chargeable in relation to the alcohol as if the value added tax were charged on the date of the sale or supply of the alcohol;

(c) “relevant person” means, in relation to premises in respect of which there is in force a premises licence

- (i) the holder of the premises licence,
- (ii) the designated premises supervisor (if any) in respect of such a licence, or
- (iii) the personal licence holder who makes or authorises a supply of alcohol under such a licence;

(d) “relevant person” means, in relation to premises in respect of which there is in force a club premises certificate, any member or officer of the club present on the premises in a capacity which enables the member or officer to prevent the supply in question; and

(e) “value added tax” means value added tax charged in accordance with the Value Added Tax Act 1994(a).

6.2 Where the permitted price given by Paragraph (b) of paragraph 2 would (apart from this paragraph) not be a whole number of pennies, the price given by that sub-paragraph shall be taken to be the price actually given by that sub-paragraph rounded up to the nearest penny.

6.3 (1) Sub-paragraph (2) applies where the permitted price given by Paragraph (b) of paragraph 2 on a day (“the first day”) would be different from the permitted price on the next day (“the second day”) as a result of a change to the rate of duty or value added tax.



Premises Licence

ANNEXES continued ...

(2) The permitted price which would apply on the first day applies to sales or supplies of alcohol which take place before the expiry of the period of 14 days beginning on the second day.

Annex 2 - Conditions Consistent with the Operating Schedule

General Conditions

Conditions imposed by JUSTICE ON-LICENCE - Licensing Act 1964, S 59, 60 and 63

1. Alcohol shall not be sold or supplied except during permitted hours.

2. In this condition, permitted hours means:

- a. ~~On weekdays, other than Christmas Day, Good Friday or New Year's Eve, 11 a.m. to 11 p.m.~~
- b. ~~On Sundays, other than Christmas Day or New Year's Eve, 12 noon to 10.30 p.m.~~
- c. ~~On Good Friday, 12 noon to 10.30 p.m.~~
- d. ~~On Christmas Day, 12 noon to 3 p.m. and 7 p.m. to 10.30 p.m.~~
- e. ~~On New Year's Eve, except on a Sunday, 11 a.m. to 11 p.m.~~
- f. ~~On New Year's Eve on a Sunday, 12 noon to 10.30 p.m.~~
- g. On New Year's Eve from the end of permitted hours on New Year's Eve to the start of permitted hours on the following day (or, if there are no permitted hours on the following day, midnight on 31 December).

3. The above restrictions do not prohibit:

- a. ~~the consumption of alcohol on the premises during the first 20 minutes after the above hours;~~
- b. ~~the taking of the alcohol from the premises (unless the alcohol is supplied or taken in an open vessel) during the first 20 minutes after the above hours;~~
- c. the consumption of the alcohol on the premises by persons taking meals there during the first 30 minutes after the above hours, if the alcohol was supplied for consumption ancillary to those meals;
- d. the consumption of the alcohol on the premises by, or, the taking, sale or supply of alcohol to any person residing in the licensed premises;
- e. the ordering of alcohol to be consumed off the premises, or the despatch by the vendor of the alcohol so ordered;
- f. the sale of alcohol to a trader or club for the purposes of the trade or club;
- g. The sale or supply of alcohol to any canteen or mess, being a canteen in which the sale or supply of alcohol is carried out under the authority of the Secretary of State or an authorised mess of members of Her Majesty's naval, military or air forces;
- h. the taking of alcohol from the premises by a person residing there; or
- i. the supply of alcohol for consumption on the premises to any private friends of a person residing there who are bona fide entertained by him at his own expense, or the consumption of alcohol by persons so supplied; or
- j. the supply of alcohol for consumption on the premises to persons employed there for the purposes of the business carried on by the holder of the licence, or the consumption of liquor so supplied, if the liquor is supplied at the expense of their employer or of the person carrying on or in charge of the business on the premises.

4. No person under fourteen shall be in the bar of the licensed premises during the permitted hours unless one of the following applies:

- a. He is the child of the holder of the premises licence.
- b. He resides in the premises, but is not employed there.
- c. He is in the bar solely for the purpose of passing to or from some part of the premises which is not a bar and to or from which there is not other convenient means of access or egress.
- d. The bar is in railway refreshment rooms or other premises constructed, fitted and intended to be used bona fide for any purpose to which the holding of the licence is ancillary.

In this condition "bar" includes any place exclusively or mainly used for the consumption of intoxicating liquor. But an area is not a bar when it is usual for it to be, and it is, set apart for the service of table meals and alcohol is only sold or supplied to persons as an ancillary to their table meals

5. There shall be no sales of intoxicating liquor other than to :



ANNEXES continued ...

- a) Members or
- b) guests or
- c) visitors as defined in Club Rules.

5. Any change in the club rules to be notified to the Licensing Authority within 14 days.

General Conditions (Cont)

**Conditions for the Management of Premises Licensed for
Public Entertainments under the Local Government (Miscellaneous Provisions) Act 1982 Part II
Indoor Sports under the Fire Safety and Safety of Places of Sport Act 1987, Part IV -**

1. Permitted Hours

1.1 The premises may be used for public entertainment, indoor spectator sports or entertainment of a like kind on:

- a) Mondays to Fridays 10.00am - 12pm.
- b) Saturdays 10.00am - 11.45pm.
- c) Sundays between 12 noon and 10.30pm
- d) New Year's Eve between 10 am and 12.30 am the following day
- e) ~~Mondays – Saturdays, on any occasion when public entertainment is being provided in accordance with the hours specified in~~
 - ~~i) an Extended Hours Order granted under Section 70 of the Licensing Act 1964~~
 - ~~ii) a Special Hours Certificate granted under Sections 76, 77 and 78 of the Licensing Act 1964~~
- ~~**PROVIDED** that the District Council has been supplied with a copy of the relevant Order or Certificate.~~
- ~~f) Any occasion when public entertainment is being provided in accordance with the hours specified in a Special Order of Exemption granted under Section 74(4) of the Licensing Act 1964.~~
- ~~g) Any occasion when public entertainment is being provided by not more than two live performers or recorded music in accordance with Section 182 of the Licensing Act 1964.~~

1.2 The premises shall **not** be kept or used for public entertainment or indoor spectator sports or entertainment of a like kind on

- a) Christmas Day (except where a licence permits entertainment to extend after 12 midnight on Christmas Eve).
- b) At any time outside the permitted hours set out in paragraph 1.1 of these conditions without the consent of the District Council being obtained.

1.3 The licensed premises shall not be open for the purposes of public entertainment on any occasion when the licensing authority may so signify their desire in writing to the Licensee that the same should not be opened.

2. Access

All parts of the licensed premises shall be open to free ingress and inspection by:-

- (a) Authorised Officers of the licensing authority.
- (b) Persons authorised in writing by the licensing authority.
- (c) Police Officers of the Suffolk Constabulary.
- (d) Fire Officers of the Suffolk Fire Authority.

3. Alterations and Maintenance

3.1 No alterations or additions shall be made to any part of the licensed premises and the fixtures and fittings therein without the prior approval of the licensing authority.

3.2 All parts of the licensed premises, including the fixtures and fittings therein, whether fixed or otherwise, shall be kept clean and maintained in good working order.



ANNEXES continued ...

3.3 The Fire Alarm and emergency lighting systems **shall be tested monthly** by the licensee to ensure that they operate effectively.

3.4 The licensee shall maintain the log book provided and **ensure that it is kept at the premises and that details of tests, etc. are entered.**

3.5 The licensee shall maintain public liability insurance not less than £5 million per claim.

4. **Licensee's Responsibilities.**

4.1 The Licensee or some responsible person nominated by him in writing shall be in charge of, and present in, the licensed premises during the whole time they are open to the public. Any such nominated person shall be provided with a copy of these licensing conditions.

4.2 The Licensee shall take all reasonable precautions for the safety of the public, performers or employees on the premises.

4.3 The numbers of persons permitted on the premises shall not exceed: ~~that specified in the licence document.~~

	<u>Ground floor</u>	<u>First floor</u>
Seated at tables	166	250
Dancing & tables	220	320
Dancing only	320	320
Closely seated	320	320

4.4 The Licensee or his nominated representative shall to the best of his ability maintain and keep order and decent behaviour on the licensed premises.

4.5 The Licensee shall not allow any lewd, obscene or indecent performance to take place on the licensed premises or allow any obscene poster, advertisement, film, photograph or programme to be displayed or shown on any part of the premises.

4.6 No exhibition, demonstration or performance of hypnotism as defined in Section 2(1a) and 5 of the Hypnotism Act 1952 shall be given by any person on the licensed premises except with the written consent of the licensing authority and in accordance with any conditions attached to such consent.

4.7 The Licensee shall ensure that Regulation 37 of the Cinematographic Safety Regulations 1955 is complied with on any occasion that the premises are used for cinematographic exhibitions.

4.8 The Licensee shall ensure that the noise level emanating from the premises remains at a reasonable level and shall comply with any requirements of ~~the Director of Environmental Services~~ Head or Health in this respect.

4.9 The Licensee shall inform the Council, in writing, of any change of his address during the period of the licence within seven days of such change taking place.

5. **Fire and Safety.**

5.1 The Licensee shall ensure compliance with the fire precautions and safety measures required by the Chief Fire Officer, as set out in the attached schedule and any conditions which may from time to time be required by the Chief Fire Officer and which have been notified to the Licensee by the licensing authority.

5.2 **Stewards:** The minimum number of stewards present when members of the public are present shall be:

- (i) up to 100 persons - 2 stewards
- (ii) for each additional 50 persons or part thereof - 1 steward.

Each steward shall be readily identifiable to members of the public and shall be instructed and trained in the following:



ANNEXES continued ...

- (i) The action to be taken upon discovering a fire.
 - (ii) The position of the exits.
 - (iii) the operation and location of the emergency lighting and fire fighting equipment.
 - (iv) Raising the alarm and correct method of calling the Fire Brigade.
 - (v) Evacuation of the public in the event of an emergency.
- 5.3 **Fire Procedure:** The Fire Brigade shall be immediately called to any outbreak of fire, however slight.
- 5.4 **Exits:** All doors indicated as exits on the attached plan shall be maintained so that they open easily and fully and the following shall apply as appropriate:
- a) Exit doors shall only be secured in such a manner that they can be immediately and easily opened from within.
 - b) Exit doors which do not open outwards shall be secured in the open position when members of the public are present.
 - c) Exit doors and the external routes therefrom shall be maintained clear and unobstructed and illuminated when members of the public are present.
 - d) Illuminated Exit signs and notices shall be properly maintained and free from obstruction.
- 5.5 **Means of Escape:** All parts of the premises used for means of escape in case of fire, shall be kept entirely free from obstruction, whether permanent or temporary, so as not to impede safe evacuation of the premises.
- 5.6 **Floors and Floor Coverings,** shall be properly maintained in a sound condition **and possess reasonable antislip properties.**
- 5.7 **Seating:** If loose chairs are used for seated audiences they shall be secured together in blocks of not less than four or more than 14 seats.
- Seats shall be arranged so as to provide gangways not less than 1.1m in width which lead to and connect with exits. No seat shall be more than 3.6 metres from a gangway measured along a row of seating.**
- 5.8 **General Lighting:** All parts of the premises and the external escape routes to which the public have access shall be suitably illuminated in the absence of adequate daylight at all times when members of the public are present.
- 5.9 **Emergency Lighting:** If the emergency lighting system is not designed to come on automatically in the event of failure of the mains lighting circuit it shall be switched on at all times when the public are present.
- 5.10 **Fire Fighting Appliances:** The fire fighting appliances indicated on the attached plan shall be maintained and immediately available for use.
- 5.11 **Drapes and Decorations:** All drapes, curtains or similar hangings shall be of such material or be so treated that they will not readily catch fire.
- No combustible effects or decorations shall be used in the premises except by permission of the licensing authority.**
- 5.12 **Electrical Cables,** flexes and other wiring must be laid in such a manner so as not to cause a hazard to those using the licensed premises.
- 5.13 **Heating Appliances:** All heating appliances shall be manufactured and installed in accordance with the appropriate British Standard and shall be properly guarded and maintained.



ANNEXES continued ...

Portable heating appliances burning liquefied petroleum gas or fuel oil shall not be used and such fuels shall not be stored in the premises when members of the public are present.

5.14 **Car Parking:** No vehicles shall be parked in such a way as to restrict the means of escape provided from the premises, or prevent the safe access and egress of the emergency services.

6. **Welfare and Hygiene.**

6.1 Where food is cooked and/or is sold on the licensed premises the licensee shall ensure that the requirements of the Food Safety Act 1990 and the Food Hygiene (General) Regulations 1970 are complied with.

6.2 Efficient and adequate means of ventilation shall be available during the whole time the public are on the licensed premises. Where mechanical ventilation is provided this shall be maintained in a safe and satisfactory condition **and detailed operating instructions shall be exhibited in a suitable prominent position.**

6.3 A sufficient number of suitable receptacles with close fitting lids shall be provided to receive and store refuse from the licensed premises.

6.4 There shall be compliance with any requirements specified by the ~~Director of Environmental Services~~ Head of Health and set out in the schedule attached to this licence and with any further reasonable requirements that from time to time may be required by the ~~Director of Environmental Services~~ Head of Health and which have been notified to the licensee by the licensing authority.

6.5 An adequate properly equipped and maintained first aid kit shall be available at the premises at all times when the public are present.

7. **General**

7.1 On those occasions when disabled or handicapped persons are present on the licensed premises such special arrangements as may be necessary in the circumstances shall be made so as to ensure all persons leave the premises safely in the event of fire.

7.2 The licensing authority reserves the right under statute after the granting, renewal or transfer of the licence at any time to dispense with or modify any of these conditions, terms and restrictions and to make additional conditions, terms and restrictions as they may deem appropriate to meet the circumstances of any particular case.

7.3 Any notice or notification in writing under these conditions shall be deemed to have been served on the licensee if:-

- (i) it is served upon the licensee personally
- (ii) it is left or posted to the licensee at his last known address
- (iii) it is left at the licensed premises.

Crime and Disorder

Public Safety

Prevention of Public Nuisance

1. The use of outside areas including the beer garden and external seating shall not be permitted after 23:00 hours.
2. The volume of the amplification system shall be strictly controlled so that noise levels are non-intrusive at nearby residential properties.



ANNEXES continued ...

3. The windows to the function room used for the playing of music shall be kept closed when musical entertainment (other than background music) is taking place.
4. The external doors to any function room used for the playing of music shall be kept firmly closed when musical entertainment (other than background music) is taking place.
5. In the event that additional ventilation is necessary to the function room, a detailed scheme shall be submitted to the Environmental Protection Section and only an approved scheme shall be fitted.

Protection of children from harm

Annex 3 - Conditions attached after a hearing by the licensing authority



LOCAL AUTHORITY



East Suffolk Council
 East Suffolk House Riduna Park
 Station Road Melton
 Woodbridge
 IP12 1RT

tel: 01394 444802
 web: www.eastsuffolk.gov.uk

Premises Details

POSTAL ADDRESS OF PREMISES, OR IF NONE, ORDNANCE SURVEY MAP REFERENCE OR DESCRIPTION

Thorpeness Country Club

The Benthills, Thorpeness, Leiston, Suffolk, IP16 4NU.

Telephone 01728 452176

WHERE THE LICENCE IS TIME LIMITED THE DATES

Not applicable

LICENSABLE ACTIVITIES AUTHORISED BY THE LICENCE

- a performance of live music
- any playing of recorded music
- a performance of dance
- provision of late night refreshment
- the supply of alcohol

THE TIMES THE LICENCE AUTHORIZES THE CARRYING OUT OF LICENSABLE ACTIVITIES

Activity (and Area if applicable)	Description	Time From	Time To
E. Performance of live music (Indoors)	Monday to Saturday	10:00am	Midnight
	Sunday	10:00am	10:30pm
F. Playing of recorded music (Indoors)	Monday to Saturday	10:00am	Midnight
	Sunday	10:00am	10:30pm
G. Performance of dance (Indoors)	Monday to Saturday	10:00am	Midnight
	Sunday	10:00am	10:30pm
I. Late night refreshment (Indoors)	Monday to Sunday	11:00pm	Midnight
J. Supply of alcohol for consumption ON the premises only	Monday to Saturday	10:00am	Midnight
	Sunday	10:00am	10:30pm

THE OPENING HOURS OF THE PREMISES

Description	Time From	Time To
Monday to Saturday	10:00am	Midnight
Sunday	10:00am	10:30pm



WHERE THE LICENCE AUTHORISES SUPPLIES OF ALCOHOL WHETHER THESE ARE ON AND / OR OFF SUPPLIES

- J. Supply of alcohol for consumption ON the premises only

NAME, (REGISTERED) ADDRESS OF HOLDER OF PREMISES LICENCE

The Hotel Folk Thorpeness Hotel & Golf Club, Lakeside Avenue, Thorpeness, Suffolk, IP16 4NH.

REGISTERED NUMBER OF HOLDER, FOR EXAMPLE COMPANY NUMBER, CHARITY NUMBER (WHERE APPLICABLE)

The Hotel Folk 3098213

NAME OF DESIGNATED PREMISES SUPERVISOR WHERE THE PREMISES LICENCE AUTHORISES THE SUPPLY OF ALCOHOL

Lynne Mair WRIGHT

STATE WHETHER ACCESS TO THE PREMISES BY CHILDREN IS RESTRICTED OR PROHIBITED







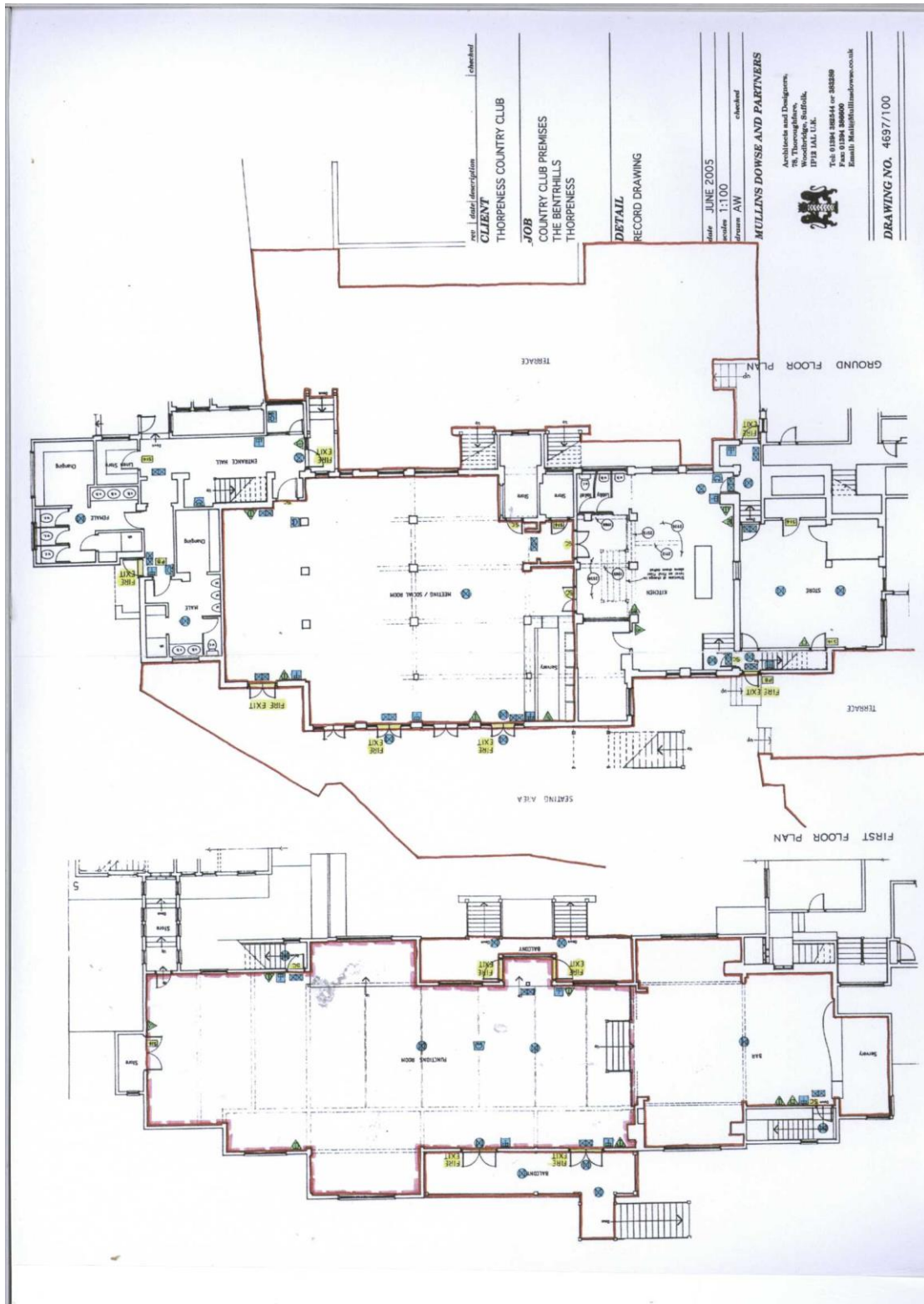





No



LICENSING ACT 2003 – ANNEX 4 – PLAN
THORPENESS COUNTRY CLUB



Schedule to Read in Conjunction With Drawing no. 4697/100.

	Exit sign internally illuminated		Fire Blanket
	Emergency lighting luminaire		Carbon Dioxide extinguisher
	Manual fire alarm call point		Dry powder extinguisher
	Fire alarm control panel		Water extinguisher
	Fire door keep locked shut		Fire alarm sounder bell
	Panic bolt/push bar fastening		Self-closing device & fire door keep shut notice

Agenda Item 5

ES/1762

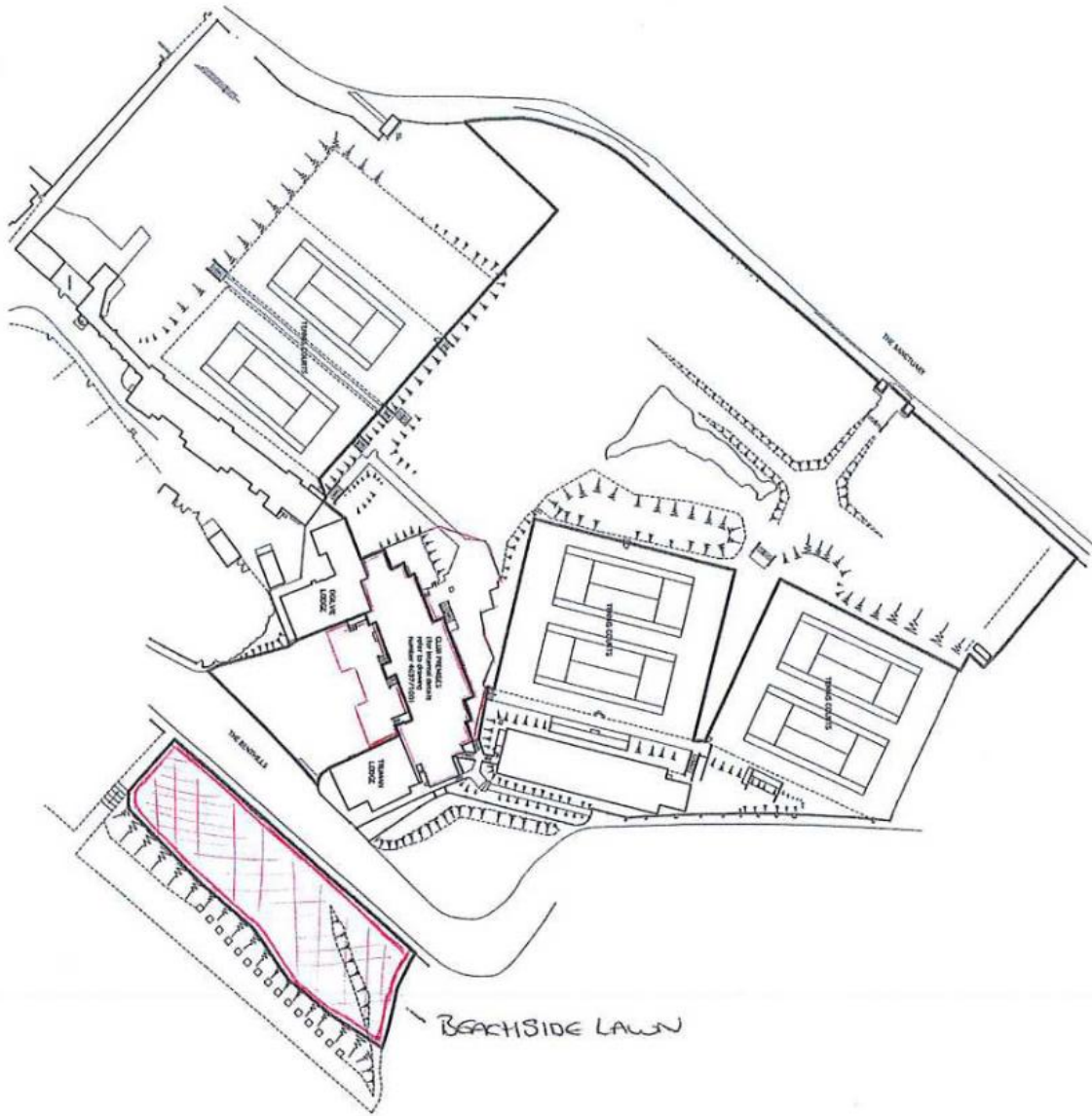

Date: JUNE 2009
 Scale: 1:500
 Author: A.W.
 Designer:

MULLINS DOWSE AND PARTNERS
 Architects and Designers,
 78, Thompsons
 Court,
 1912 Vile, U.K.
 Tel: 01784 32244 or 32275
 Fax: 01784 32265

Job:
 THORPNESS GOLF CLUB & HOTEL LTD
 COUNTRY CLUB
 THORPNESS

Detail:
 RECORD DRAWING

Drawing No. 4637/101