

Item: 9

DC/21/270/FUL

Provision of new replacement accessible beach access ramp over sea defence wall.

Martello Ramp (adjacent New Cafe) Corner of Sea Road / Orford Road, Felixstowe



Site context



Block plan

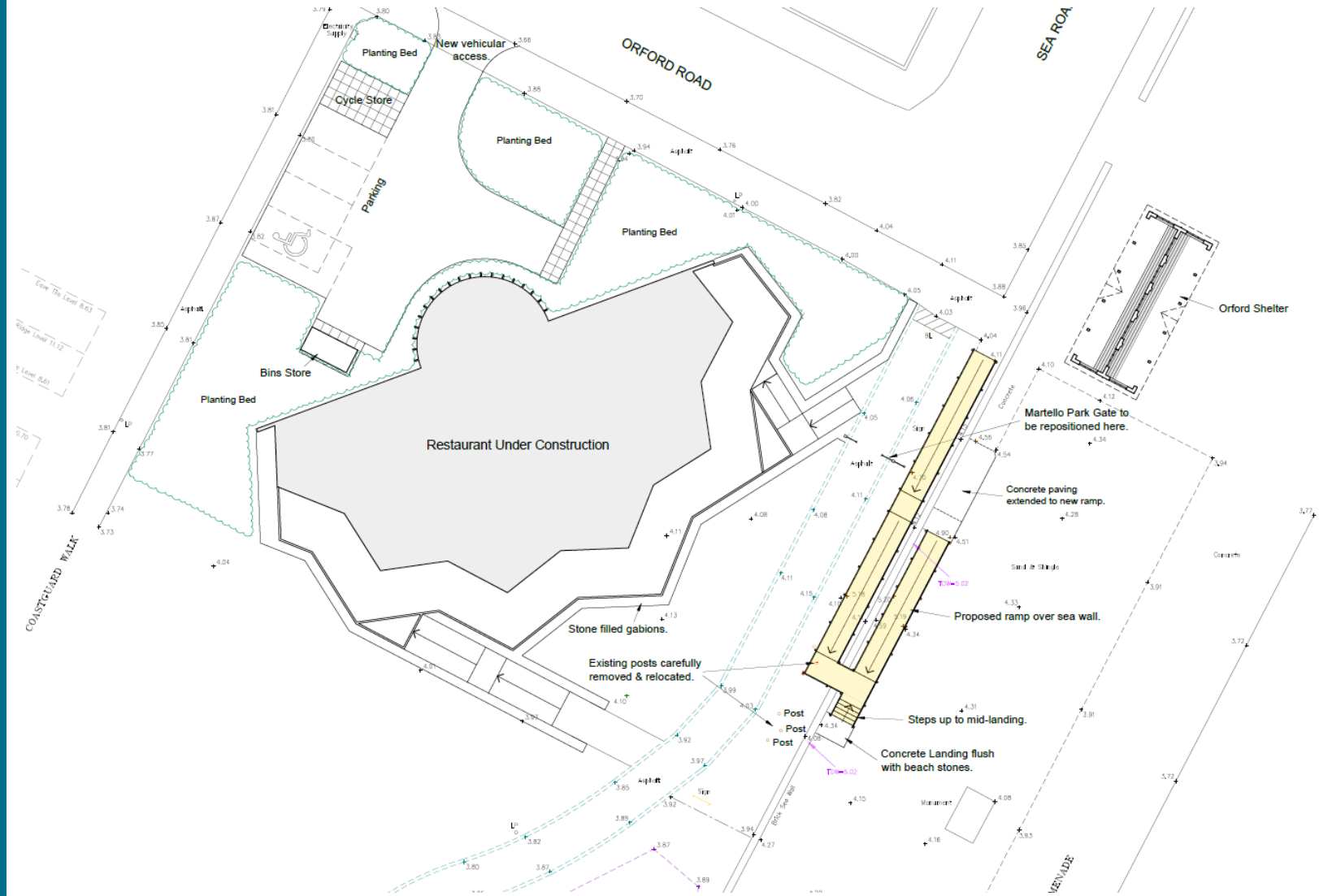

Site location plan

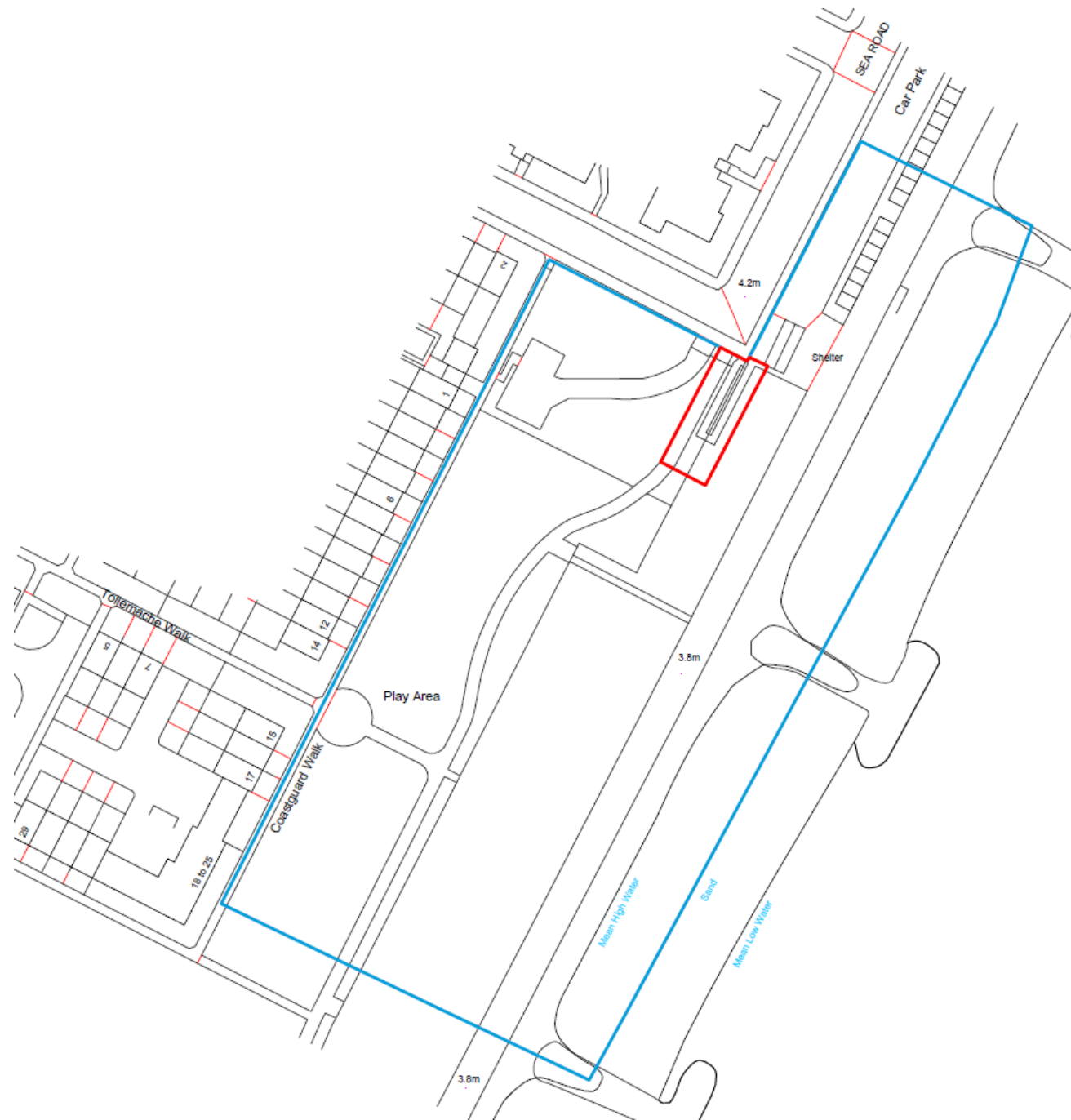

Existing elevations



Existing West Elevation 1:100

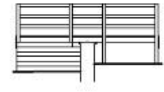

Existing South Elevation 1:100

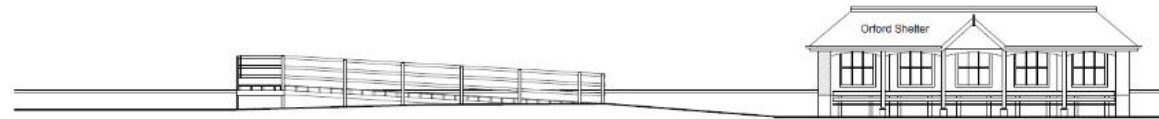

Existing East Elevation 1:100



Promenade Side

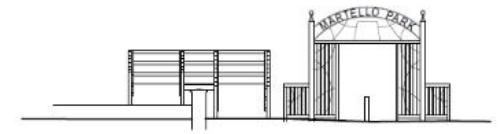

Existing North Elevation 1:100

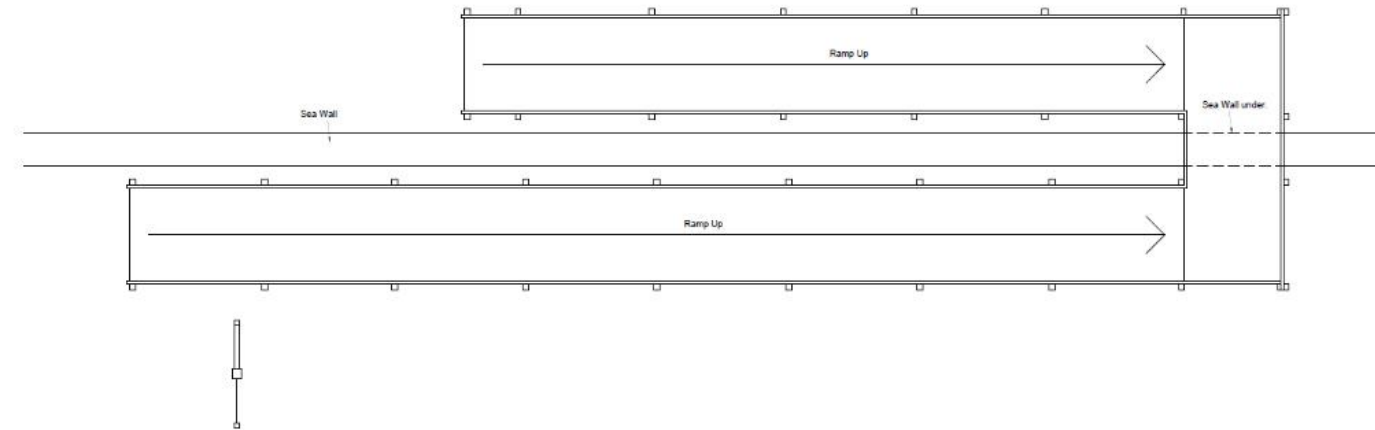

Entrance gate to
Martello Park

Martello Park

Site photos



Site photos



Site photos



Proposed elevations

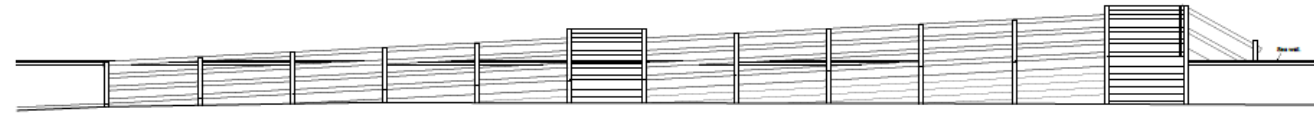

Proposed West Elevation 1:50

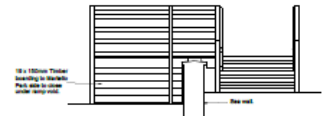

Proposed South Elevation 1:50

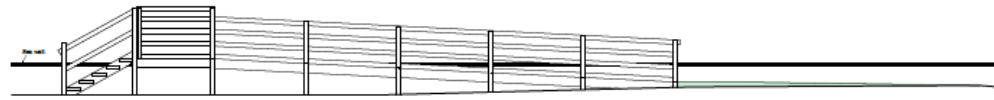

Proposed East Elevation 1:50

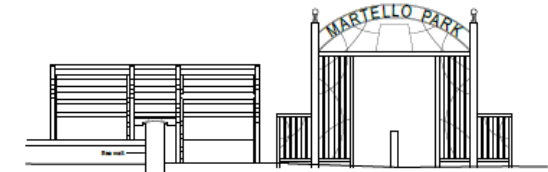

Proposed North Elevation 1:50

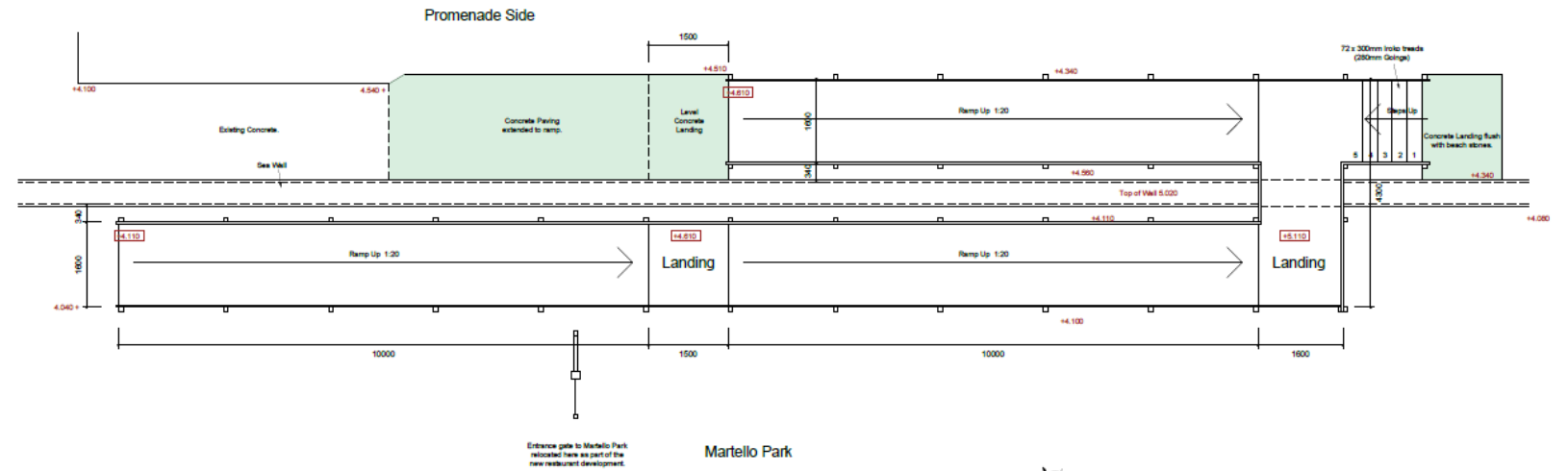

Material planning considerations

- Design/visual amenity
- Coastal management and flood risk

Recommendation

Authority to approve subject to the consideration of any formal comments received from the Environment Agency and confirmation from East Suffolk Council Coastal Management team that the submitted Coastal Erosion Vulnerability Assessment satisfies their requirements.

Proposed conditions as outlined within the report – summarised below:

- Time
- Plans
- Materials
- Agreement regarding liability
- Coastal Erosion Vulnerability Assessment (CEVA)